



The GMC Motorhome. Every journey is an adventure.

We hide our best work where it does the most good.

A GMC Motorhome is a lot more than a truck with a box in back. To be sure, our years of experience in truck and bus manufacture have had an important bearing on its design. But this is a motorhome built from an idea. The idea being to build a great motorhome from the ground up.

You'd have to cut apart a GMC Motorhome, as we've done here, to see all the innovative thinking that goes into our chassis. Like eliminating the driveshaft and rear axle with the use of front-wheel drive. An important point, for it allows a low floor, which makes entry and exit an easy step up or down. And it creates a lower profile for a pleasing appearance.

Rear suspension posed a real challenge, because our motorhome

had to fulfill a variety of functions. For example, it had to be able to soak up bumpy roads, as well as cruise the Interstate. So, in the rear, you'll find four wheels in tandem. Not dual. Suspended on air, not stiff steel springs. This happy combination smooths the ride and produces a wide stance.

In tandem, the rear wheels don't protrude into passenger space.

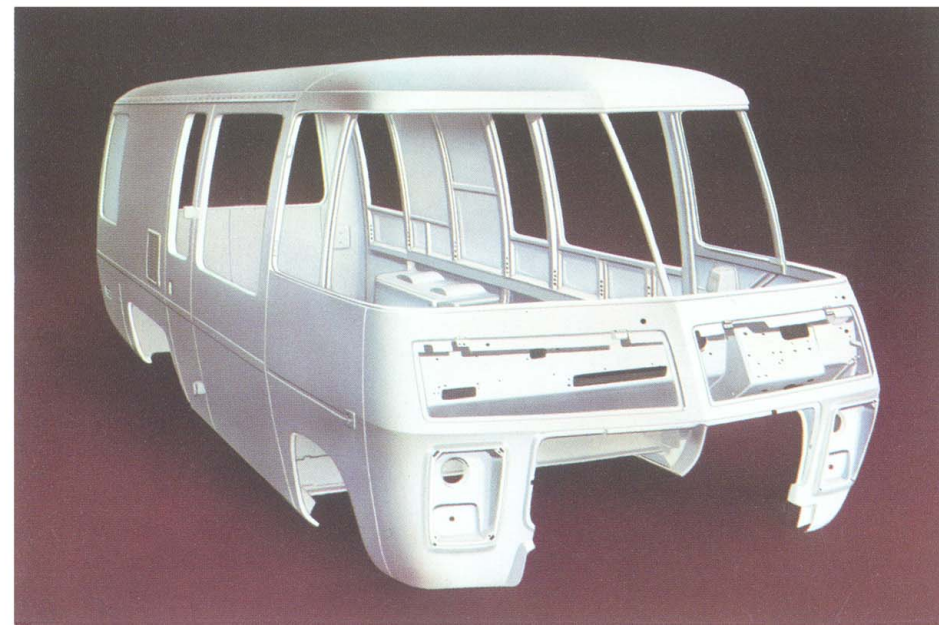
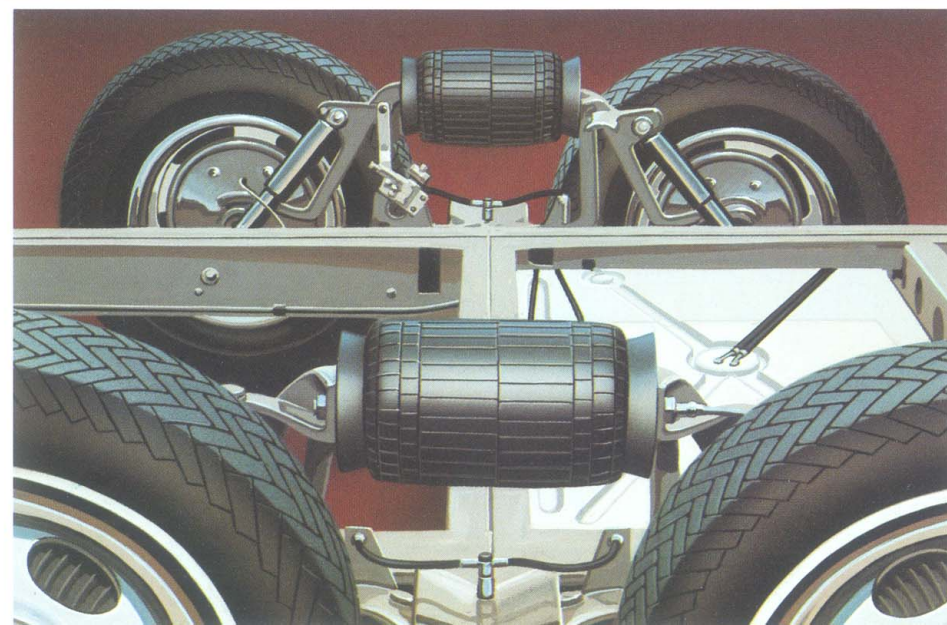
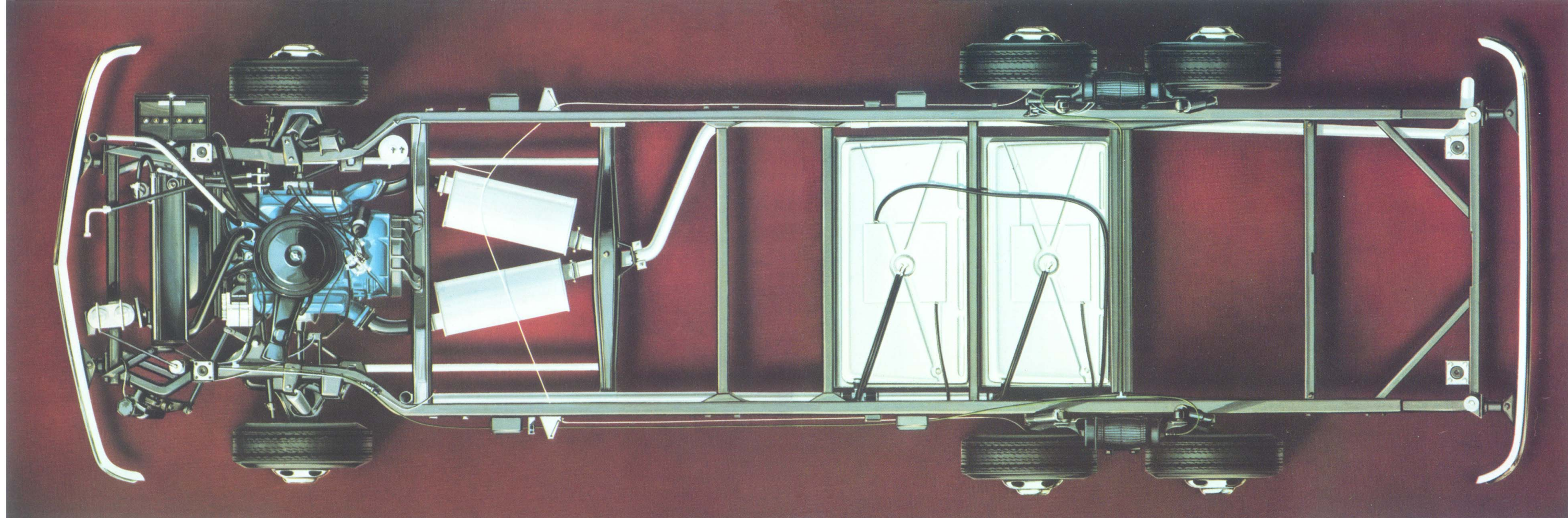

We also wanted to provide a lasting structure for you to travel in. So, on top of the wide steel chassis, we've put a cage of aluminum ribs and stringers—like an aircraft fuselage. Then, on top of this tough substructure, we've bonded skin panels with the same technique used on jumbo jets. The lower skin panels, as well as the nose and rear sections, are molded fiberglass for a fine surface finish and resistance to corrosion. The roof and upper side panels are lightweight mirror-smooth aluminum, which helps keep the center of gravity low for impressive handling.

There's an automatic height control valve to keep the rear suspension at the desired height under varying load conditions. A power leveler for campsite use is available. And the front suspension is torsion-bar sprung, with a stabilizer bar.

In the rear, there are four large, finned drum brakes. Even the parking brake is applied to all four wheels. In front, power discs supply the braking.

Finally, we've worked to reduce three things you don't want inside your GMC Motorhome: extremes of heat, cold, and noise. Comfortable temperatures and quietness result from three-quarter-inch thick, foam-in-place polyurethane insulation. It's sprayed over the entire inner surface of the body shell before the interior is installed. Millions of tiny air bubbles, embedded in the foam, produce a barrier against noise and temperature extremes.

An interior as comfortable as the home you leave behind.

Step aboard a GMC Motorhome. Look around inside. We believe you'll want to keep it a long time, so you'll find some of the same durable, easy-to-care-for materials used in a modern home.

Check the heavy-use areas, like counter tops and the exterior wall surfaces of the bath and wardrobe module. All are faced with an attractive, tough, and scuff-resistant simulated walnut surface made of low-pressure laminate. It resists stains, water spills, and heat. And it's easy to clean.

Exceptional touches are everywhere. Cabinet fronts are louvered wood on the Kingsley and Palm Beach models. And sculptured on Eleganza II. Drawers are hand-sanded to avoid snagging clothes and have tongue-in-groove construction with glued joints (no staples), just like fine furniture. Counter tops have rounded corners, and overhead cabinets are flush-sided. Knobs are eliminated. Hinges concealed. And you'll find more closet hanging space than ever before.

It's this sort of regard for detail that distinguishes every GMC Motorhome.

The galley features a double sink of stainless steel with a single-handle faucet control. The three-burner range and oven are LP gas. And the electric refrigerator is a spacious 7½ cubic feet (6 cubic feet in the twin-bed floor plan) with a separate freezer compartment.

Seating-area cushions feature fine upholstery over foam and metal-

spring construction from one of America's leading furniture makers. And you'll appreciate the three-stage reclining dinette unit with flip-up sides on the table. Choose two seating positions. Or convert the seats to a bed. Or remove the table completely for extra room.

Large windows all around lend an open, airy feeling to every GMC Motorhome. When windows are open, full-size aluminum screens let the outside air in and keep winged nasties out. When windows are closed, window seals virtually eliminate the problem of airborne dirt creeping in. Two double-crank screened roof vents with available 2-speed fans provide added fresh-air flow.

Extra thought even went into the draperies. They are fabric-backed for long life and dirt resistance. A special fastening system makes them easy to open and close, or to remove for cleaning. Another feature: Draperies slide easily and have a neat pleated appearance.

No detail was too small to consider. The molded bath module includes a flex-hose shower head. And a sliding-door medicine cabinet with tempered-glass mirror. And molded sink and Aquamagic® III toilet.

The furnace is a 30,000-BTU, high-capacity Solaire model with instant "ON" thermostat control. Nice for those winter sojourns. For warmer weather, single or dual roof-mounted air conditioning units are available.

In short, we at GMC have made every effort to make our motorhome a snug harbor for happy families.



For 1977, each GMC Motorhome model features five different floor plans. So you can choose the one that's best suited to you and your family. At GMC, we believe your home should be a reflection of you.

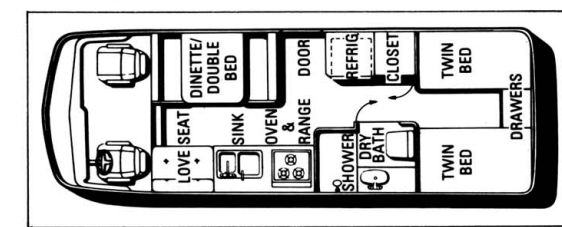
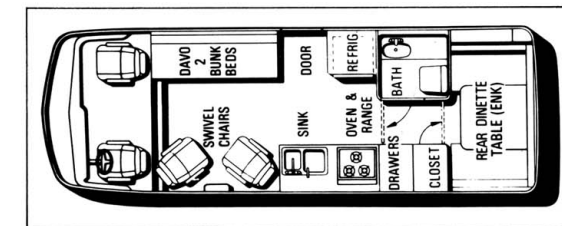
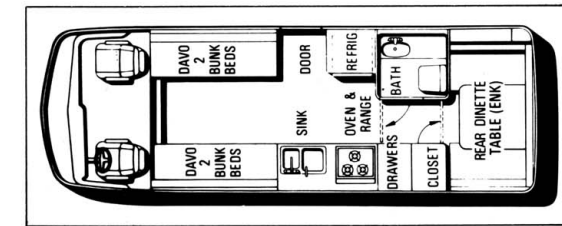
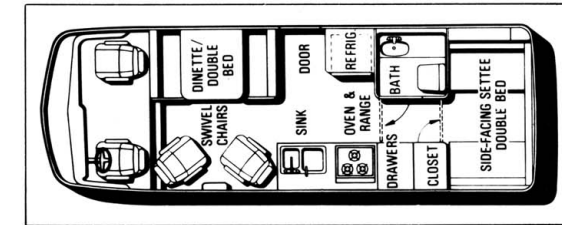
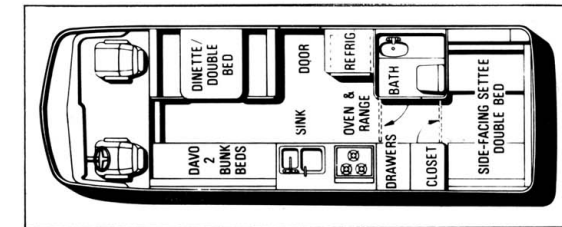



Kingsley

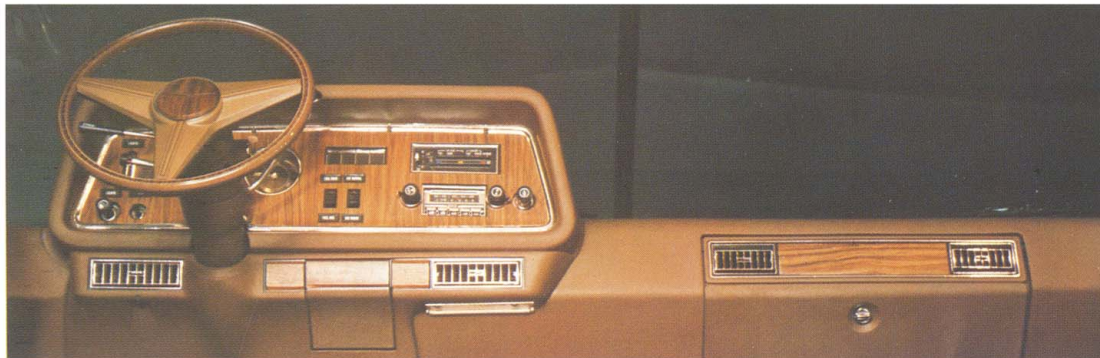
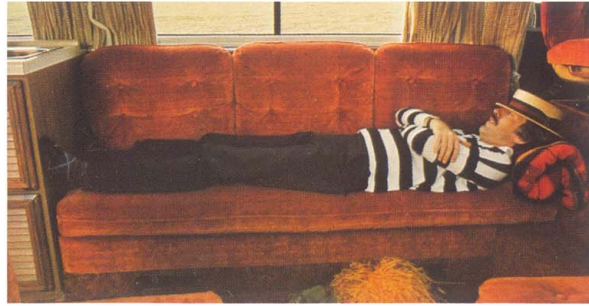

Kingsley exhibits the high quality inherent in fine homes. The rust-colored interior is beautifully appointed. For added luxury, thick shag carpeting and simulated walnut paneling abound. Luxurious, yes; but functional as well.

The Kingsley is shown here with a davo which converts to bunk beds. And the dinette converts to a double bed.





Palm Beach



Palm Beach features bright and pleasing green plaid upholstery, as well as solid lime green driver and passenger seats. Plush green shag carpeting and walnut paneling abound. Craftsmanship is evident throughout. Interior cabinetry is crafted from real wood.

Palm Beach is shown here with the rear side-facing settee/double bed. The dinette converts to a double bed and across the room are two comfortable swivel chairs separated by a convenient flip-up table.

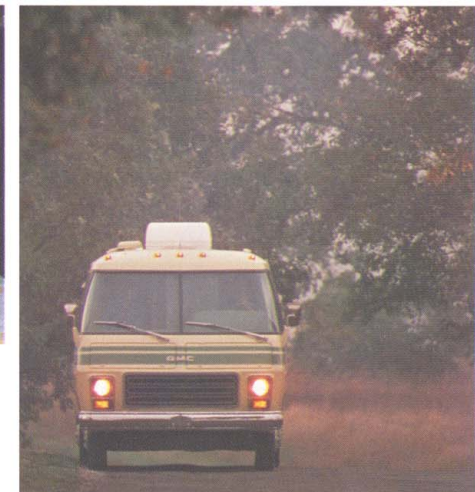



Eleganza II



Eleganza II offers a plush environment in which to relax, sleep, dine . . . or just chat with friends. The interior features handsome beige velour. All colors are beautifully coordinated.

Eleganza II is shown here with the basic floor plan for 26-foot GMC Motorhomes. The forward dinette converts to a double bed. The couch converts to upper and lower bunks. And the side-facing settees, in the rear, convert to a second double bed. There's no shortage of comfortable sleeping and seating accommodations.

FACTS AND FIGURES THAT WILL TICKLE YOUR FANCY.

Engine

Gasoline—GMC 403, 8-cylinder, V-type.
Air Cleaner—Oiled Paper Element.
Cooling Capacity—21 Quarts.
All-season Coolant, (–20°F),
Fan—Seven-blade, 19-inch.
Emission Control—Conforms to Federal Standards.
Oil Filter—Throwaway-type, 1-quart Capacity.
Engine Oil Cooler.
High-Energy Ignition System.

Transmission

Three-speed Turbo Hydra-matic, 425 with Cooler.
Final Drive Ratio, 3.07:1.

Rear Axle

Independently Suspended Tandem Wheels
(Non-driving), Capacity—7,500 lbs. at Ground.
Air Suspension with Leading & Trailing Arms.
Two Height Control Valves.
Shock Absorbers—Four, 1-inch-diameter Piston.

Front Axle

Torsion Bar Independent Suspension.
Rated Capacity 4,200 lbs. at Ground.
Shock Absorbers—Two, 1-inch-diameter Piston.
Steering—Integral Gear, Power.
Steering Column—Tilt.
Turning Diameter curb to curb—56.4 ft.

Brakes

Type:
Disc, Front—Drum, Rear (Four).
Vacuum-boosted, with Dual (Split) System.
Size:
Front—Disc-type, 11" x 1.205".
Rear—Drum-type, Four, 11" x 2".

Chassis

Frame—Ladder-type, Welded with 6 x 2.50 x .125
Channel.
Bumpers. Formed Steel, 2-piece Front and Rear.
Energy Absorbers—2 Front and 2 Rear.

Fuel and Exhaust

Fuel Tanks—Two 25-gallon w/Fuel Tank Gauge
Selector Switch.
Exhaust. Dual Mufflers and Single Tailpipe.

Body

Substructure:
Heavy-gauge Aluminum Extrusions.
Body Materials—Fiberglass Front & Rear Caps &
Lower Side Panels, Aluminum Upper Side Panels
& Roof.
Insulation—Sprayed-in-place Urethane Foam.
Floor—¾" Treated Plywood with 1" Polyurethane
Insulation.
Side Door—28" Width.

Windows

Windshield—Two-piece Laminated Soft-Ray Tinted.
Side and Rear Windows—Solid-tempered, Tinted.
Living Area Windows—Two, Screened & Sliding.
Bedroom Rear Window—Pop-out Escape Feature.

Environmental Equipment

Heating—LPG Furnace, 30,000 BTU, Forced Air—
Cold Air Return.
Fire Extinguisher—2½ lb.
Water Supply—36-gallon Polyethylene Tank with
12V Demand Water Pump.
Hot Water Heater—6-gallon, 110V, Glass Lined.
City Water Hook-up System with Locking
Fill-cap Door.
Disposal—32-gallon System Polyethylene Tank.
110V AC—25-ft., 40-amp. Power Cord.
LPG—62-pound Propane Tank.
Interior Electrical.
12V DC Electrical System with 45-amp.
AC/DC Battery Converter/Charger.
All Lights 12V.
Battery—12-volt, 150-amp./hour.

Interior Finishing

Ceiling—Vinyl-covered Composite acoustical Panel.
Paneling—¾" Wood Grain Panel.
Drapery—All Windows Except Windshield &
Driver's Compartment Side Windows.
Driver Compartment Divider Drape.
Carpet.

Driver & Passenger Compartment

Air Conditioning—Automotive-type.
Adjustable Contoured Driver & Single Passenger
Swivel Seats & Seat Belts.
Mirrors—Two, Painted, Outside (7½" x 10½")
Foldaway.

Inside Rearview Mirror.

Left- & Right-hand Sunshades.
Ashtrays—Two.
Dome Lamps—Driver & Passenger.
Safety Padded Dash.
Automotive Heater & Defroster.
Glove Compartment.
Map Pocket—Driver & Passenger.
Instruments & Controls.
Windshield Wiper/Washer, Variable-speed
Hydraulic Wipers.
Gauges—Heater & Defroster, Lighter, Speedometer,
Fuel, Temp., Oil, Gen.
Brake Warning Light.
Key Buzzer Warning System.
Telltale Light—Door Open.

Galley Area

Refrigerator—7½-cu.-ft. on All Except, 6-cu. on
Twin Bed Models. All-electric, 12V/110V.
Range—3-burner with Oven & Hood,
12V Fan & Light.
Sink—17" x 24" Stainless Steel, Double Bowl
w/Ledge Back & Swing-spout Faucet.
Cabinets—Under and Over Sink & Refrigerator.

Bathroom

Two-piece Molded Fiberglass-reinforced Plastic
w/Shower & Curtain
Separate Shower Stall on Twin Bed Models.
Sink and Faucet.
Medicine Chest w/Mirror.
Aquamagic® III Toilet.

Electrical

Battery—73-amp./hour Automotive.
Alternator—12V, 80-amp. Delcotron.
Headlights—Single, 7" High-intensity.
Amber Front Turn Directionals.
Lights—Combination Stop, Tail, Turn & Backup.
Five Amber (Two Clearance, Three Identification)
Marker Lamps Upper Front.
Five Red Marker Lamps Upper Rear (Two Clearance,
Three Identification).
Side Markers—Front & Rear with Reflectors, Front
Flash with Turn Signals.
Emergency Flasher—4-way.
Porch Light.

Wheels, Tires

Tires—Six, 8.75 x 16.5 (D Load Range) Blackwall.
Maximum Tire Capacity (Ea.) 2350.
Wheels—16.5-K. 8 Stud with 6½" Bolt Circle.
Offset, 5.00".

Available Equipment

**Air Conditioning—Roof-mounted, Duo-Therm, Single or
Dual**
Auxiliary Motor Gen.—6,000 w Onan.
Cruise Control
Suspension Leveler—Power-assisted
Radio, AM/FM Stereo w/4 Speakers
Radio, AM/FM Stereo w/Tape Player & 4 Speakers
**AM/FM Stereo Tape Player with 40 channel
CB Radio & Antenna**
Table—Driver's Compartment
Clock—Battery-operated
Cabinets—Overhead, Right, Front.
Cabinets—Overhead, Left, Front.
**Toilet—Thetford Electromagic™, Recirculating
Water Treatment Unit**
Vacuum Cleaner—Built-in
Sliding Side Door Window & Galley Window w/Screen
Ventilator—Roof, Front & Rear Power Exhaust.
**Lamp—Engine Compartment w/Retractable Cord for
Trouble Light**
Trailer Wiring Harness
Outlet—110V Electrical, Outside
Bumpers—Chrome, Front and Rear
Mirrors—Stainless Steel
Wheel Covers—Disc
Skirts—Rear Suspension Bellows
Radial and Whitewall Tires

GMC Truck & Coach Division reserves the right to make changes at any time without notice in prices, colors, materials, equipment, specifications and models and also to discontinue models. Data shown is basic information for the prospective buyer effective at time of issuance of this pamphlet. Dealer will provide complete up-to-date information on available equipment, specifications, etc. not shown here.

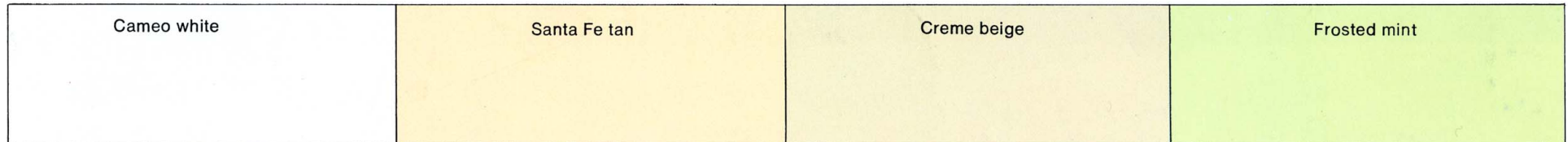

THE MOTORHOME FROM GENERAL MOTORS

