

Ford F Series.



Have you driven a Ford... lately?





There aren't many trucks that can stand up to the F150.

Whether it is a 2WD or 4WD, a ute or chassis cab. F150s have been described as awesome.

They're big, they're tough and they're reliable. Proving themselves time and time again at work and at play.

They have a bigger engine than any other one-tonne ute in Australia. A new 5.8 litre EFI V8.

Designed to generate 157 kW of power at 3800 rpm, along with 425 Nm of torque at 2800 rpm.

Which will tow an impressive 2800* kg.

The electronic fuel injection system manages this brute strength to help it run smoothly and start easily in



extreme temperatures.

A simple flick of the switch in the cabin allows you to select either one of the F150's two fuel tanks, which have a total capacity of 138 litres.

The F150 features a rear anti-lock braking system, usually only found on more expensive passenger cars.

It helps to compensate for those occasions when you'll have a less than even weight distribution between axles. Along with limited slip differential, it makes the F150 particularly well mannered.

And easily handled in the wet.

Handling, of course, is enhanced by variable ratio power steering and front and rear, anti-sway stabiliser bars.

To help smooth-out rough roads, F Series features twin I-Beam independent front suspension, matched to semi-elliptic springs in the rear.

Outside, the F150 is stylish and good looking.

The F150 ute can be ordered with a distinctive two-tone paint treatment which is available at extra cost.



Those who want a ute with even more style can, for a little extra, choose the optional XLT pack.

It includes carpeting, double door seals, a rear step bumper and black tonneau cover.





Tray shown available through your Ford Dealer at extra cost.

A double-wall tailgate and side panels are standard on the F150 ute. As is a tough, ladder-frame chassis.

All of which add to the F Series renowned strength of construction. It has the longest load bed in its class, so there's plenty of space for a tonne of payload.

F150, with the widest cabin in its class, provides both driver and passengers with ample room to stretch out and enjoy the ride.

A three-across bench seat provides firm but comfortable support for long journeys.

The robust new 5-speed overdrive manual features wide gear spacing for easy highway driving, or a low 'crawler' first gear.

On the ute, you can order an automatic transmission at extra cost.

Along with comprehensive instrumentation, there's an AM/FM stereo radio cassette.

The F150. Whether you choose the 2WD, 4WD ute or chassis cab, it's tough to beat.

*Depending on State regulations and tow bar design capacity.

CHECK OUT THE RANGE AT A GLANCE.

Model Range	2WD 5.8L V8 Petrol	4WD 5.8L V8 Petrol	Manual Trans	Auto Trans	Max. Payload**	MT Pack	Iron Tone Paint***
F150 Ute	X	X	X	Opt	1060	Opt	Opt
F150 Cab Chassis	X	X	X	N/A	1250	N/A	N/A
F Series Ambulance	X	N/A	N/A	X	1260	N/A	N/A

Maximum payload includes crew, spares, tools, equipment and payload. *With MT pack only, at extra cost.

All Ford vehicles sold throughout Australia are backed by Fordcare after sales service. Fordcare is comprised of a number of individual service products designed exclusively for Ford vehicles and their drivers. These include technical support back-up, diagnostic equipment, approved Ford/Motorcraft replacement parts and parts and service warranties.



This brochure is designed to provide you with a general introduction to the Ford Products (including available optional equipment) referred to, and should be read in conjunction with the latest specification sheet. Because of changes in conditions and circumstances Ford* reserves the right, subject to all applicable laws, at any time, at its discretion, and without notice to discontinue or change the features, designs, materials, colours and other specifications and the prices of its products, and to either permanently or temporarily withdraw any such products from the market without incurring any liability to any prospective purchaser or purchaser.

The latest specifications sheet should be referred to for information on the availability, ordering and use of optional equipment. Always consult an Authorised Ford Dealer for the latest information with respect to features, specifications, prices, optional equipment and availability before deciding to place an order.

*FORD MOTOR COMPANY OF AUSTRALIA LIMITED. (Incorporated in Victoria.) Registered Office: 1735 Sydney Road, Campbellfield, Victoria 3061.

Have you driven a Ford... lately?



FORD F SERIES RANGE



4x4 F-150 & F-350 UTILITY & CHASSIS CAB — 1991 M.Y.

CHASSIS CAB MODEL
(3378 WB)

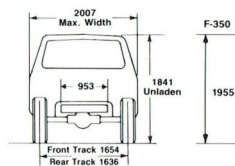
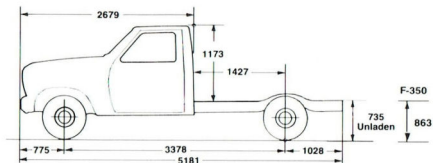

UTILITY MODEL
(3378 WB)

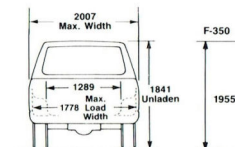
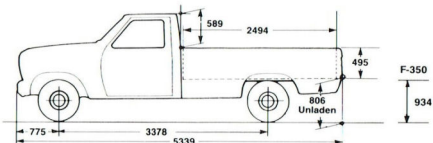

4x2 F-150 UTILITY & CHASSIS CAB — 1991 M.Y.

CHASSIS CAB MODEL
(3378 WB)

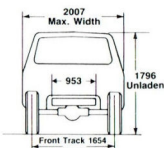
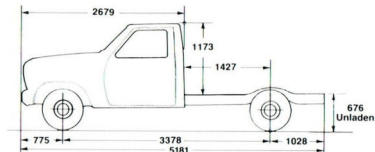

UTILITY MODEL
(3378 WB)

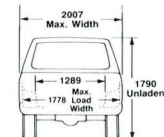
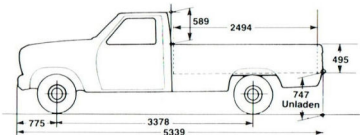

4x2 F-SERIES AMBULANCE CHASSIS CAB — 1991 M.Y.

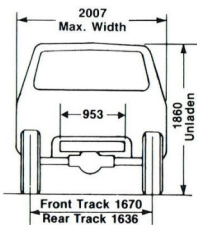
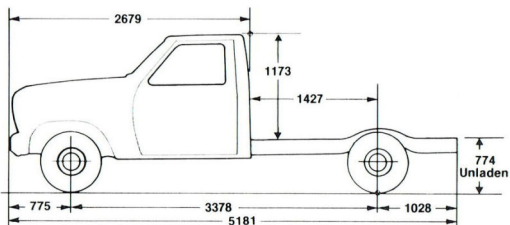

Have you driven a Ford...lately?

MECHANICAL FEATURES (ALL MODELS)

ENGINE

- Ford 5.8 litre EFI V/8 (unleaded petrol);
- †Nett power at specified RPM 157kW (SAE) @ 3800;
- †Nett torque at specified RPM 425Nm (SAE) @ 2800
- Poly-Vee Serpentine drive belt
- Specifications: ● Type 8-cyl, 90° Vee, Overhead Valve; ● Displacement (litres) 5.8; ● Bore and Stroke (inches) 4.00x3.5; ● Compression Ratio (to 1) 8.8; ● Main Bearings 5; ● Valve lifters hydraulic;
- Fuel Injection System Multi-port;
- Ignition electronic

- Features: ● Eight port synchronous single-fire strategy fuel injection system;
- New intake air system with remote mounted air cleaner assembly;
- Modern, lightweight cylinder block;
- EEC-IV electronic engine controls including: heated exhaust gas oxygen sensor; ● Speed-density air flow measurement system; ● Reduced back-pressure exhaust system; ● Self-adjusting hydraulic valve lifters; ● Five steel-backed copper-lead main bearings; ● Positive rotators on exhaust valves

FUEL SYSTEM

- 138 litre capacity
- 66 litre fuel tank mid-frame mounted
- 72 litre fuel tank alt-axle mounted

STEERING

- Power steering (Bendix variable ratio, Ratio 11-17.5:1)

MASS DATA		F-150 4x4		F-350 4x4		F-150 4x2		
		Utility	Chassis Cab	Utility	Chassis Cab	Utility	Chassis Cab	Ambulance
GVM	(kg)	3100	3100	3900	3900	3000	3000	3370/3170†
KERB MASS	(kg)	2040	1850	2330	2140	1940	1750	1910
MAX PAYLOAD	(kg)	1060	1250‡	1570	1760	1060	1250‡	1460/1260
SEATING CAPACITY		3	3	3	3	3	3	2
RECOMMENDED BODY DIM. (mm) (SUBJECT TO STATE REGULATIONS)		—	2950 x 2100	—	2950 x 2100	—	2950 x 2100	—
MASS DISTRIBUTION								
FRONT	(kg)	1200	1200	1280	1280	1100	1100	1150
KERB MASS * REAR	(kg)	840	650	1050	860	840	650	760
TOTAL	(kg)	2040	1850	2330	2140	1940	1750	1910
TOWING DATA # MAX TRAILER MASS RATED	(kg)							
— WITHOUT BRAKES		750	750	750	750	750	750	750
— WITH BRAKES		2800	2800	3400	3400	2800	2800	2800
GCM	(kg)	5000	5000	5900	5900	5000	5000	5000
FRONT AXLE		1610	1610	2086	2086	1542	1542	1769
FRONT TYRES (T.R.A.A. RATING)		1800	1800	2800	2800	1800	1800	2400
FRONT SUSPENSION @ GROUND		1655	1655	1782	1782	1598	1598	1526
FRONT RATING		1610	1610	1782	1782	1542	1542	1526
REAR AXLE		1701	1701	2841	2841	1701	1701	2841
REAR TYRES (T.R.A.A. RATING)		1800	1800	2800	2800	1800	1800	2400
REAR SUSPENSION @ GROUND		1711	1711	3452	3452	1891	1891	2140
REAR RATING		1701	1701	2800	2800	1701	1701	2140
TURNING CIRCLE (KERB TO KERB)	(m)	13.8	13.8	15.7	15.7	13.6	13.6	14.5

† HIGHER GVM AVAILABLE WITH OPTIONAL UPRATED REAR SPRINGS

‡ MAXIMUM PAYLOAD INCLUDES OCCUPANT, BODY, EQUIPMENT AND LOAD

* KERB MASS INCLUDES ALL FLUIDS, FULL FUEL, LESS DRIVER AND PASSENGER.
KERB MASSES ARE CALCULATED AND SUBJECT TO VARIATION.

DEPENDING UPON STATE REGULATIONS, A FORD APPROVED TOW BAR AND AN APPROPRIATE LOAD LEVELLING HITCH.

PLEASE NOTE

■ 1. This specification sheet contains a general description only of the Ford Product referred to on the sheet, its specifications and features and the optional equipment which is currently available for use on it or connected with such product. Generally the optional equipment referred to is available at extra or variable cost. Certain optional equipment can only be used or ordered in combination with other optional equipment. ■ 2. The illustrations, information and specifications presented and referred to in this specification sheet were correct at the time when the specification sheet was approved for printing. However, Ford Motor Company of Australia Limited reserves the right, subject to the laws of Australia and/or any applicable State or Territory thereof and/or the regulations of any competent Authority which may apply from time to time, at its discretion at any time and without prior notice to discontinue or change the models, features, specifications, designs and prices of the product referred to in this sheet and any optional equipment therefor without incurring any liability whatsoever to any purchaser or prospective purchaser of any of such products. ■ 3. All capacities, measurements, dimensions and weights quoted in this specification sheet are approximate only. ■ 4. Because of the possibility of changes in models and the information, specifications, features, standard equipment and optional equipment of or to the product referred to in this specification sheet a prospective purchaser is strongly advised to consult an Authorised Ford Dealer for the latest information on models, specifications, features, standard equipment, optional equipment, prices and availability before placing an order. ■ 5. From time to time deliveries are delayed by causes outside the reasonable control of Ford Motor Company of Australia Limited, or its Authorised Ford Dealers. When an order has been placed, please keep in touch with your Authorised Ford Dealer.



*FORD MOTOR COMPANY OF AUSTRALIA LIMITED
A.C.N. 004 116 223
Registered Office: 1735 SYDNEY ROAD,
CAMPBELLFIELD, VICTORIA, 3061

PRINTED APRIL 1991