

# The 2013 S-Class



Mercedes-Benz  
The best or nothing.

The pioneering spirit of Gottlieb Daimler and Wilhelm Maybach lives on at Mercedes-Benz. Always at the forefront of engineering technology and superior craftsmanship, our passion has always been to create automobiles that move in more ways than one. With the 2013 S-Class, our principles live on.

## The S-Class

<b>DESIGN</b>	2
<b>ENTERTAINMENT &amp; COMMUNICATION</b>	10
<b>BlueEFFICIENCY &amp; 4MATIC™</b>	12
<b>AGILITY</b>	14
<b>SAFETY</b>	16
<b>AMG</b>	18
<b>COLOURS &amp; MATERIALS</b>	20
<b>ACCESSORIES &amp; OWNERSHIP</b>	26
<b>WEBSITE, TEST DRIVE, EQUIPMENT LISTING &amp; TECHNICAL SPECIFICATIONS</b>	28





S 550 4MATIC™ Sedan.



S 550 4MATIC™ Sedan.



## One look is all it takes.

The captivating design of the S-Class is unlike any other automobile on the road. Up front, the distinctive radiator grille commands attention while Active Bi-Xenon headlamps with LED design illuminate the road ahead. The exterior mirrors with large lenses and LED indicators also complement the body and capture attention from onlookers.



S 550 4MATIC™ Sedan LED taillights.

## Exquisite from every angle.

Beauty is in the details. A wide bumper with integrated tailpipes at the rear gives the S-Class an unmistakable look of power. LED rear lighting throughout emotes sheer confidence. The 19" AMG 5 triple-spoke alloy wheels<sup>1</sup> themselves make quite a statement. Even from a distance the S-Class is art defined.



<sup>1</sup>Not available on the S 63 AMG Sedan and S 65 AMG Sedan.



S 550 4MATIC™ Sedan.



S 400 HYBRID interior.





## Take luxury on the road.

Almost every aspect of the S-Class can be tailored to your desire. Luxurious interior finishes such as fine-quality leather and rich wood trims are plentiful while the available Premium Rear Seating Package<sup>1</sup> with Climate comfort rear seats and Luxury rear headrests provide superior rear seating comfort. Heated 16-way power-adjustable front seats provide substantial comfort in cold weather and the THERMOTRONIC automatic climate control system permits both driver and front seat passenger to set their own temperature preferences. No comfort is compromised in the S-Class.



The S-Class interior stands as the pinnacle for exceptional luxury and passenger comfort.

<sup>1</sup>Not available on the S 600 Sedan and S 65 AMG Sedan.

## Pushing engineering and innovation to a higher level.

A marvel of Mercedes-Benz engineering, the S 350 BlueTEC Sedan, is the one and only diesel in its class. Its economical engine delivers 240 hp and 455 lb-ft of torque, giving it the smooth and exceptional performance one would expect from a Mercedes-Benz.



The 3.0 L BlueTEC turbodiesel V6 engine.

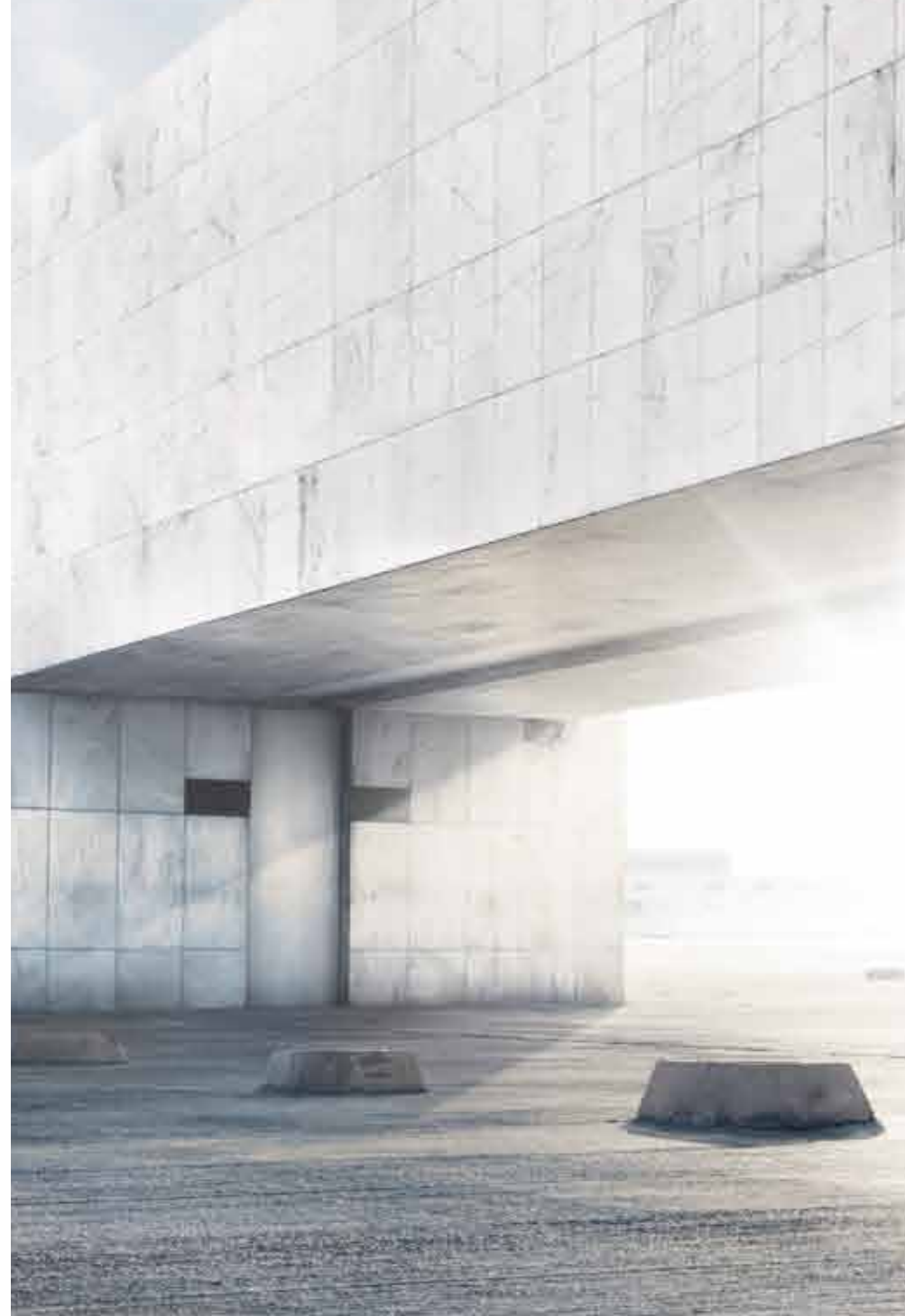



S 350 BlueTEC Sedan.

## Take command with COMAND.

The Mercedes-Benz COMAND APS with navigation control and display system is one of the most advanced in the world. For safe, hands-free communication, the COMAND system includes a remote control, SD card slot and Bluetooth. You can also choose to control components by voice with the LINGUATRONIC voice-control system.

The harman/kardon® LOGIC7® 600-watt surround sound system comes standard on the S-Class. Aided by Dolby Digital 5.1, it offers a full three-dimensional sound experience. For a whole new dimension in listening pleasure, there is the BANG & OLUFSEN performance surround sound system. Standard on the S 600 Sedan and S 65 AMG Sedan and optional on all other S-Class models, it delivers 1,200 watts of stunning sound quality. Also included with either exceptional sound system is an MP3-compatible 6-disc DVD changer and an auxiliary audio/video input in the glove box.

Additionally, SiriusXM is standard and includes a 6 month complimentary subscription<sup>1</sup> featuring over 120 channels of the best in audio entertainment. Get 100% commercial-free music from every genre, plus sports, news, talk and comedy – all with crystal-clear, coast-to-coast coverage.



harman/kardon® LOGIC7® surround sound system.



<sup>1</sup>Complimentary service is comprised of a SIRIUS package. Monthly subscription required for service thereafter. © 2012 Sirius XM Canada Inc. "SiriusXM", the SiriusXM logo, channel names and logos are trademarks of Sirius XM Radio Inc. and are used under licence.



The S 550 4MATIC™ Sedan interior featuring COMAND APS.



## Leader, in every sense of the word.

As a world-class sedan – one by which all others are measured against – the S-Class has brought several landmark innovations to the market.

The S 400 HYBRID Sedan is powered by a muscular 6-cylinder gasoline engine and by a compact yet high-powered electric torque motor. Its optimized aerodynamics, recuperation of braking energy and low friction tires make it the most efficient and responsible vehicle in the luxury class.

The only diesel in its segment, the S 350 BlueTEC Sedan also delivers without compromise. It can catapult to 100 km/h in only 7.1 seconds, while being extremely resourceful with fuel. The standard 7G-TRONIC PLUS automatic transmission also helps to deliver outstanding performance while improving overall fuel economy.



## Experience four seasons of control with 4MATIC™.

The S 350 BlueTEC Sedan and S 550 4MATIC™ Sedan come standard with our fourth generation, fully automatic, permanent all-wheel drive system. It works seamlessly with our Electronic Stability Program (ESP®), enhancing your all-wheel advantage through curves in rain or snow.

Our 4MATIC™ permanent all-wheel drive technology also incorporates our 4-Wheel Electronic Traction System (4ETS) which monitors each wheel for the first sign of slippage, and can individually brake slipping wheels to maintain the balance of power or reduce excess torque.

By continuously ensuring that power goes to the wheels with more grip, 4MATIC™ can assist even if only one wheel has traction<sup>1</sup>. This ensures optimum control in all seasons and during all road conditions.

<sup>1</sup>No system, regardless of how advanced, can overcome the laws of physics or correct careless driving. Please always wear your seat belt. Best performance in snow is obtained with winter tires.



S 550 4MATIC™ Sedan.

## Dynamic performance and optimum agility.

### V6 ENGINE

The S 400 HYBRID Sedan is the most fuel-efficient large luxury sedan in the world. It takes HYBRID technology to the next level with the first series production of lithium-ion batteries, which are lighter and more efficient than existing hybrid batteries. With its combined gas and electric motor output of 295 hp and 284 lb-ft of torque – the S 400 HYBRID Sedan accelerates from 0-100 km/h in 7.2 seconds.

### V8 and V12 ENGINES

The S 550 4MATIC™ Sedan is equipped with a 4.6 L Bi-turbo V8 engine that generates a maximum power of 429 hp and 516 lb-ft of torque. The use of lightweight materials such as magnesium results in an optimized power output and a broader torque curve, reducing fuel consumption even further. The powerful Bi-turbo V12 engine of the S 600 Sedan is quite literally twice the engine you'll find in many other cars, with 510 hp and 612 lb-ft of torque at only 1,800 rpm.

### 7G-TRONIC PLUS AUTOMATIC TRANSMISSION

The 7G-TRONIC PLUS automatic transmission creates an ideal relationship with the S 350 BlueTEC 4MATIC™ and S 550 4MATIC™ Sedan, delivering power with exceptional fluidity. Its close-ratio, 7-speed design delivers low noise levels, fast and smooth shifting, responsiveness and superior fuel economy.

For supreme ride comfort, the S-Class is also equipped with either the AIRMATIC air suspension<sup>1</sup> or the Active Body Control (ABC) suspension system<sup>2</sup>. AIRMATIC provides better comfort and agility than ever, while ABC-equipped vehicles use sophisticated sensing systems to continuously adapt the suspension to driver input and variable road conditions.



19" AMG 5 triple-spoke wheels  
(Code 754)<sup>3</sup>



19" AMG 5 triple-spoke wheels  
(Code 752)<sup>4</sup>



19" multi-spoke wheels<sup>5</sup>



20" forged AMG  
5 twin-spoke wheels<sup>6</sup>



20" AMG 5-spoke wheels  
(Code 778)<sup>7,8</sup>



20" AMG 5-spoke wheels  
(Code 789)<sup>9</sup>

<sup>1</sup>Standard on the S 350 BlueTEC Sedan, S 400 HYBRID and S 550 4MATIC™ Sedan. Not available on all other models. <sup>2</sup>Standard on the S 600 Sedan, S 63 AMG Sedan and the S 65 AMG Sedan. Not available on all other models. <sup>3</sup>Standard on the S 350 BlueTEC Sedan and S 550 4MATIC™ Sedan. Not available on all other models. <sup>4</sup>Standard on the S 400 HYBRID Sedan. Available on the S 600 Sedan as part of an option package. Not available on all other models. <sup>5</sup>Standard on the S 600 Sedan. Not available on all other models. <sup>6</sup>Standard on the S 63 AMG Sedan and S 65 AMG Sedan. Not available on all other models. <sup>7</sup>Available on the S 350 BlueTEC Sedan and the S 550 4MATIC™ Sedan as a standalone option. Not available on all other models. <sup>8</sup>Not available on the S 550 4MATIC™ SWB Sedan. <sup>9</sup>Available on the S 400 HYBRID Sedan as a standalone option. Not available on all other models.



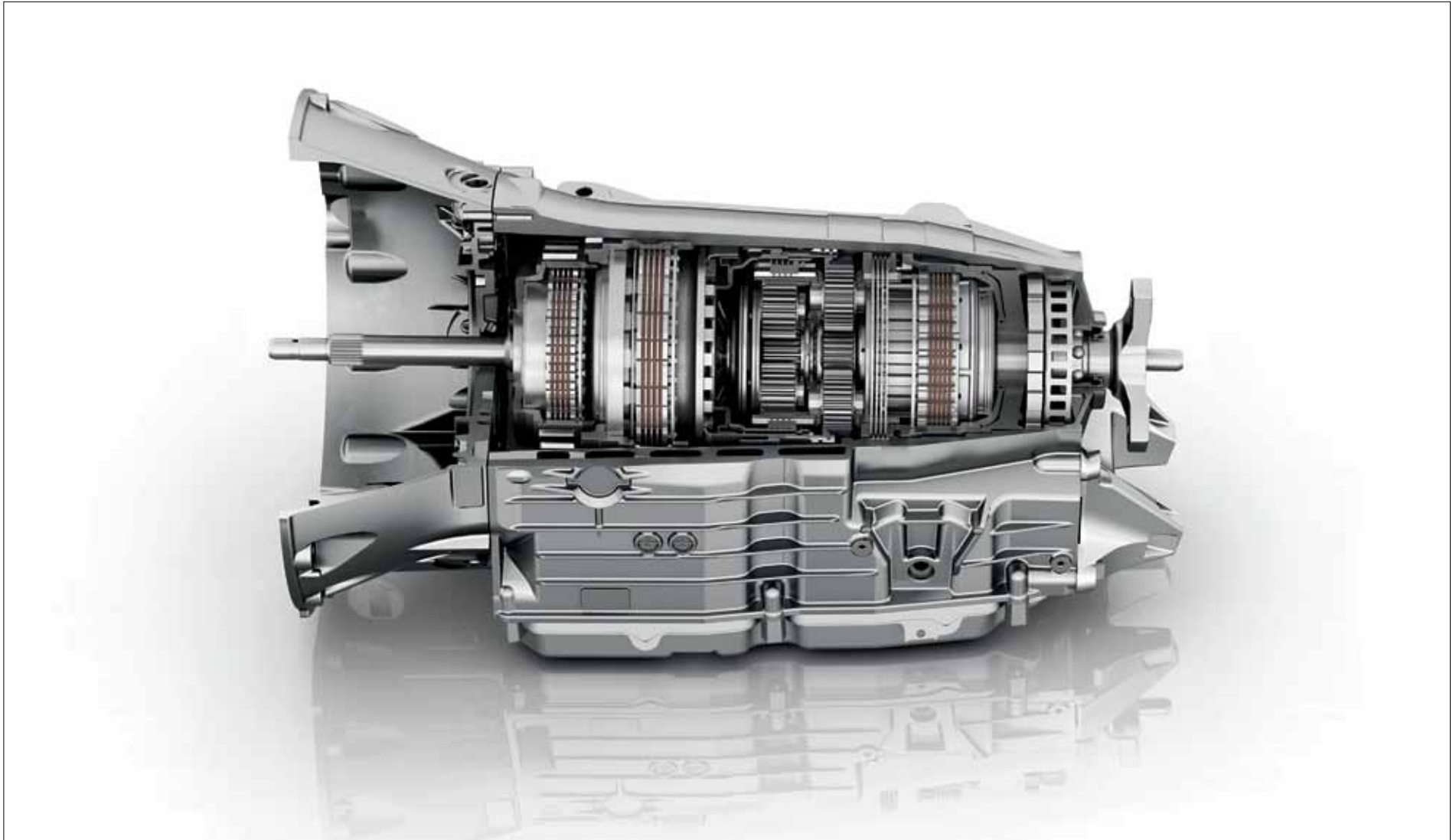

The 7G-TRONIC PLUS: one of over 18 million automatic transmissions produced in a period spanning more than 50 years.

## The integral safety concept from Mercedes-Benz.

The S-Class and its integral safety concept reaffirm the Mercedes-Benz position as a safety originator. With it, our vision of accident-free driving has moved one step closer to reality.

Working together, the technologies within the S-Class help to protect you before, during and after an accident. From vehicle motion, stability, braking, to even lighting, many sensors and programs work together to monitor your vehicle and adjust as needed to provide you the ultimate protection.

For optimum protection, the body of the S-Class employs a series of reinforced crumple zones to protect you in the event of an accident. The S-Class further benefits from the protection of an 8 airbag<sup>1</sup> system, including two-stage front airbags and front and rear side-impact airbags.

In the urgent moments just after an accident, our built-in technology even aids rescue efforts. Following a collision, our intelligent system automatically carries out a range of safety measures: the engine shuts off and hazard signals and emergency interior lighting switch on, the side windows are partially lowered and the doors are unlocked.

Mercedes-Benz understands that when it comes to safety, time is of the essence.

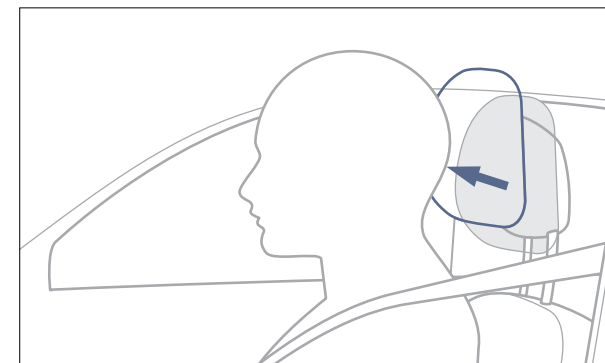

NECK-PRO head restraints

<sup>1</sup>WARNING: The forces of a deploying airbag can cause serious or fatal injuries to a child under age 13. Children under 13 should be seated in the back seat if possible. See Operator's Manual for additional warnings and information on airbags, seatbelts and child seats.



8 standard airbags provide optimal protection in the event of a collision.

## Power becomes you.

For the ultimate in performance, the S-Class is also offered in two unique and powerful AMG models.

Under the hood, the S 65 AMG Sedan possesses an AMG 6.0 L V12 Bi-turbo engine that delivers a staggering 621 hp and 738 lb-ft of torque. This kind of torque needs to be harnessed with a 5-speed automatic transmission with AMG SPEEDSHIFT enhancements. 0-100 km/h is achieved in only 4.4s, making the S 65 AMG one of the world's quickest four-door sedans.

The S 63 AMG Sedan boasts the AMG 5.5 L Bi-turbo V8 engine with 563 hp and 664 lb-ft of torque. Combined with the AMG SPEEDSHIFT MCT 7-speed sports transmission, it accelerates from 0-100km/h in 4.4s.

Both the S 63 AMG Sedan and the S 65 AMG Sedan are equipped with Active Body Control (ABC), which uses special AMG spring struts with firmer damping. ABC reduces body roll in cornering, squat under acceleration and front-nose dive during braking.

Each of these AMG jewels also incorporates unique exterior and interior styling features, including special leather and detailing, two chromed dual tailpipes, a front apron with enlarged air intakes, side skirts, a rear apron and unique AMG alloy wheels.



The muscular rear of the S 63 AMG Sedan defines its athletic character.



S 65 AMG Sedan interior.



20" forged AMG 5 twin-spoke wheels.



S 63 AMG Sedan.

## An expression of character.

The finishing touches can mean the difference between a work of art and a true masterpiece. Whichever colour you opt for, you've made the right choice. With a selection of both solid and metallic paint finishes benefitting from an extra scratch-resistant clear coat, your S-Class colour is less susceptible not only to scratches, but also to sunlight, temperature variations, dust and soot.



LEATHER <sup>1</sup>	Black/Black	Cashmere Beige/Savanna Beige	Alpaca Grey/Basalt Grey	Chestnut Brown/Black	Sahara Beige/Black	PASSION LEATHER <sup>2</sup>	Black/Black	Cashmere Beige/Savanna Beige	Alpaca Grey/Basalt Grey	Chestnut Brown/Black	Sahara Beige/Black	EXCLUSIVE PASSION LEATHER <sup>3</sup>	Black/Black	Cashmere Beige/Savanna Beige	Alpaca Grey/Basalt Grey	Chestnut Brown/Black	Sahara Beige/Black
----------------------	-------------	------------------------------	-------------------------	----------------------	--------------------	------------------------------	-------------	------------------------------	-------------------------	----------------------	--------------------	--	-------------	------------------------------	-------------------------	----------------------	--------------------

### SOLID PAINT

Black	●	●	●	●	●	●	●	●	●	●	●	●	●	●	●	
Calcite White	●	●	○	●	●	●	●	○	●	●	●	●	○	●	●	
METALLIC PAINT																
Magnetite Black	●	●	●	●	●	●	●	●	●	●	●	●	●	●	●	
Obsidian Black	●	●	●	●	●	●	●	●	●	●	●	●	●	●	●	
Periclase Green	○	●	○	○	●	○	●	○	○	●	○	●	○	○	●	
Andorite Grey	●	○	●	○	○	●	○	●	○	○	●	○	●	○	○	
Peridot Brown	●	●	○	○	●	●	●	○	○	●	●	●	○	○	●	
Dolomite Brown	●	●	○	●	●	●	●	○	●	●	●	●	○	●	●	
Carneol Red	●	○	●	●	●	●	○	●	●	●	●	○	●	●	●	
Iridium Silver	●	○	●	●	○	●	○	●	●	○	●	○	●	●	○	
Palladium Silver	●	○	●	○	○	●	○	●	○	○	●	○	●	○	○	
Diamond White	●	●	○	●	●	●	●	○	●	●	●	○	●	●	●	
Cavansite Blue	○	○	●	●	●	○	○	●	●	●	○	○	●	●	●	

● Recommended combination ○ Possible Combination

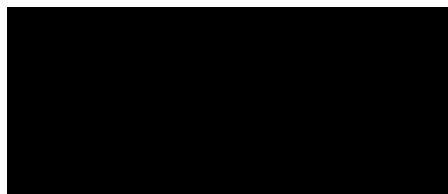
**SOLID PAINT**

040 Black

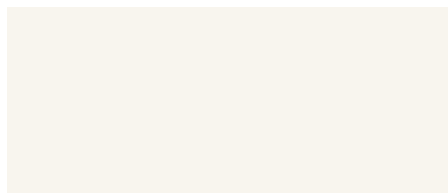

650 Calcite White

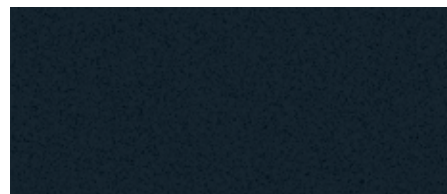
**METALLIC PAINT (OPTIONAL)**

183 Magnetite Black

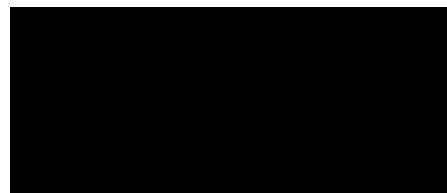

197 Obsidian Black



300 Periclase Green



370 Andorite Grey

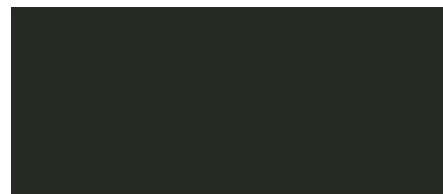

474 Peridot Brown

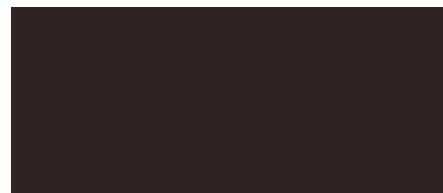

526 Dolomite Brown



544 Carneol Red

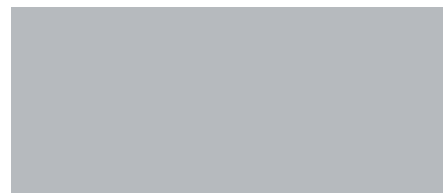

775 Iridium Silver



792 Palladium Silver

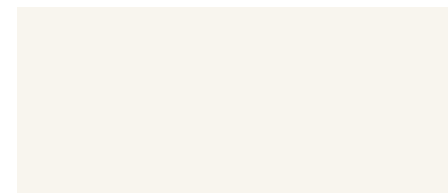

799 Diamond White



890 Cavansite Blue

**LEATHER<sup>1</sup>**



211 Black/Black



274 Chestnut Brown/Black



214 Cashmere Beige/Savanna Beige



275 Sahara Beige/Black

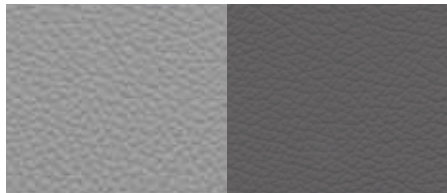

218 Alpaca Grey/Basalt Grey

**PASSION LEATHER<sup>2</sup>**

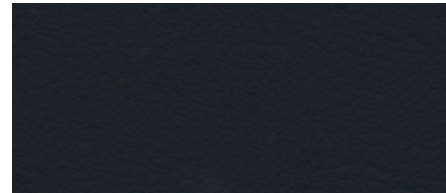

821 Black/Black

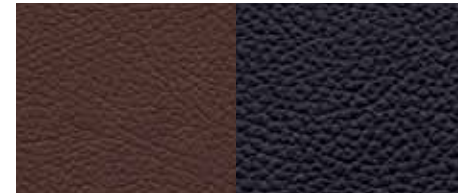

885 Chestnut Brown/Black



824 Cashmere Beige/Savanna Beige



884 Sahara Beige/Black

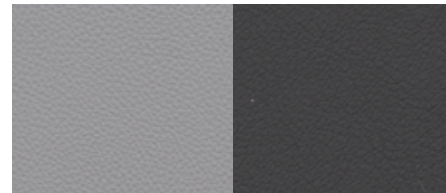

828 Alpaca Grey/Basalt Grey

<sup>1</sup>Standard on the S 350 BlueTEC Sedan, S 550 4MATIC™ Sedan and S 400 HYBRID Sedan. Not available on the S 600 Sedan, S 63 AMG Sedan and S 65 AMG Sedan. <sup>2</sup>Available on the S 350 BlueTEC Sedan, S 550 4MATIC™ Sedan, S 400 HYBRID Sedan and S 63 AMG Sedan. Not available on the S 600 Sedan and the S 65 AMG Sedan. <sup>3</sup>Only available on the S 600 Sedan and S 65 AMG Sedan.



**EXCLUSIVE PASSION LEATHER<sup>3</sup>**

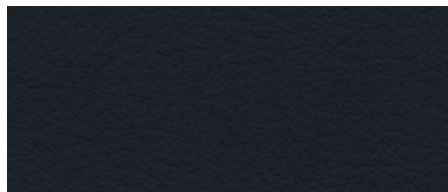

911 Black/Black

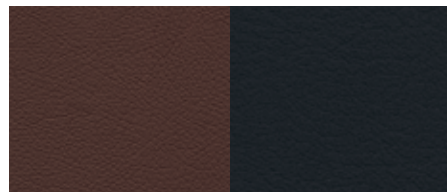

964 Chestnut Brown/Black



914 Cashmere Beige/Savanna Beige

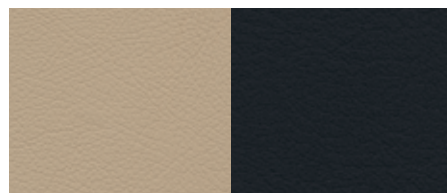

965 Sahara Beige/Black

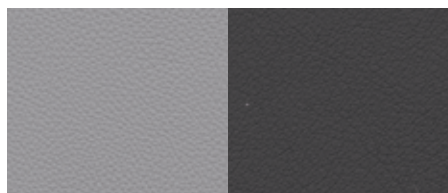

918 Alpaca Grey/Basalt Grey

**TRIM**



731 Burl Walnut (high-gloss)



H18 Brown Poplar



736 Dark Ash



H73 AMG Carbon Fibre

## Exclusive design.

To further enhance your driving experience, the S-Class also features the Mercedes-Benz *designo* palette of exquisite leathers, hand-selected woods and exotic exterior colours. Enjoy the rich look and feel of hand-fitted *designo* Nappa leather or lustrous *designo* wood trim that is individually selected for harmonious appearance and hand-finished to give you true old-world craftsmanship. Choose from an extensive array of handsome exterior paint colours.

Each element is brought together under the expert eye and skilled hand of a master craftsman to create an S-Class that is truly a reflection of you.



Exclusive appointments provide an unmatched interior character.



Fine detailing hand crafted to perfection.



The S-Class interior adorned in *designo* leather upholstery.

## Accessorize to personalize.

All Mercedes-Benz Genuine Accessories are designed and manufactured to the highest standards for fit, appearance, quality and function. They are an ideal way to blend the distinctive Mercedes-Benz style with your own. Ask us for more information on the complete lineup of S-Class Accessories.



### Illuminated Door Sill Panels

The blue illuminated Mercedes-Benz lettering is activated every time you open the door to get in or out. These illuminated door sill panels, in stainless steel, add a further “highlight” to the S-Class.



### Roof Rack and Box

Need even more cargo carrying capacity? The S-Class roof rack and box is an ideal solution. We have something to fit all of your needs with multiple sizes available.



### 20" Two-Tone Split 10-Spoke Wheels

Personalize your S-Class with these unique black and polished wheels. They are sure to make a statement wherever your journey takes you.



### Trunk Tray

Help protect the cargo area of your S-Class with this custom fitted trunk tray. Formed from durable, easy-to-clean plastic to fit your vehicle.

## A passion for things done right.

A passion for craftsmanship and attention to detail – it's what you'd expect from Mercedes-Benz, setting us apart from all other manufacturers. It drives us to set new standards in design, performance, comfort and safety. To continually build on the legendary traditions of Mercedes-Benz, and to provide you with an ownership experience that includes the valuable benefits described below.

### **24-hour Roadside Assistance**

During the basic warranty coverage of 48 months and the time duration of the optional Extended Limited Warranty, Mercedes-Benz Roadside Assistance will be at your service. We'll bring you some gas, replace a flat tire with your spare, or jumpstart your car. In the event of a mechanical breakdown, if attempts by our Roadside Assistance technician have not made your vehicle safely operable, towing service will be provided to the nearest Mercedes-Benz dealership. Assistance is available 24 hours a day, every day, to anyone driving a Mercedes-Benz anywhere in Canada or the continental U.S.<sup>1</sup>

### **Wear and tear period**

The following parts listed are covered for wear and tear during the first 24 months or 40,000 km, whichever comes first. Brake pads, brake discs, brake pad wear sensors and light bulbs.

### **Mercedes-Benz warranties**

The Mercedes-Benz New Vehicle Limited Warranty covers defects in materials or workmanship for 48 months or 80,000 km, whichever comes first. To widen your window of confidence, you can opt for a Mercedes-Benz Extended Limited Warranty as well.<sup>2</sup>

### **Customer service**

Owning a Mercedes-Benz means that when you have a question, we're here to help. Customer Service is open from 9 a.m. to 5 p.m. EST, Monday through Friday, and is staffed with knowledgeable Mercedes-Benz experts who can talk you through the finer points of working your car's audio system – or even assist you in locating the nearest Mercedes-Benz dealership. Just call 1-800-387-0100. It's that simple.

### **Trip interruption reimbursement**

If a breakdown covered by your New Vehicle Limited Warranty or optional

Extended Limited Warranty occurs more than 80 km from your home, leaves your Mercedes-Benz vehicle inoperable or unsafe to drive, and requires overnight repairs, we've got you covered. You will be reimbursed up to \$500 for hotel accommodations and up to \$600 for alternative travel expenses per incident while your car is being repaired at an authorized Mercedes-Benz dealership.

<sup>1</sup>Vehicle must be accessible from main roads. Roadside Assistance may involve charges for parts, service and towing. Depending on the circumstances, these services may be provided by an outside service provider, courtesy of Mercedes-Benz Roadside Assistance. For full details of the Roadside Assistance Program, please see your dealer. <sup>2</sup>Please see your dealer for warranty details as well as for terms, conditions and pricing for extended warranty options.

## Mercedes-Benz is virtually yours.

Visit [mercedes-benz.ca](http://mercedes-benz.ca) and open an online window to Mercedes-Benz Canada. Revel in the incredible photography of our vehicles and get a visceral impression of what it would be like to see yourself behind the wheel. Access information about any of our vehicles, including financing and leasing options, upcoming models, and configure your dream Mercedes online. Our website also offers details about the Mercedes-Benz Extended Limited Warranty, vehicle ownership, and much more on the fascinating story behind one of the world's most recognizable brands.

## To be continued. With a test drive.

Nowhere is your S-Class so convincing as on the road. It's only there that you can fully experience the superior handling and power that makes this car so special. Feel the engine move you forward, and watch your heart rate rise with the speedometer. That unique feeling in your stomach cannot be put down on paper. That's why we would like to invite you in for a test drive at your local Mercedes-Benz dealer. Reserve your appointment today, or visit [mercedes-benz.ca](http://mercedes-benz.ca). We look forward to seeing you.



# The 2013 S-Class

EQUIPMENT LISTING & TECHNICAL SPECIFICATIONS

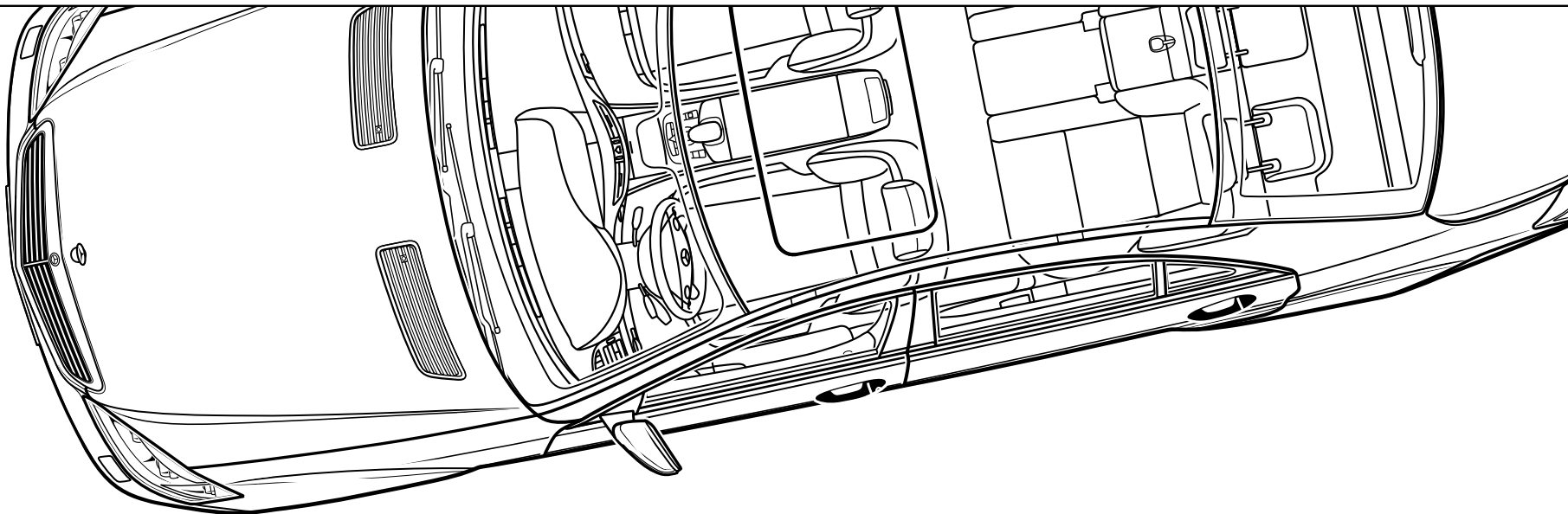

Mercedes-Benz

The best or nothing.







## Technical data:

	<b>S 350 BlueTEC SEDAN</b>	<b>S 400 HYBRID SEDAN</b>	<b>S 550 4MATIC™ (SHORT WHEELBASE) SEDAN</b>	<b>S 550 4MATIC™ (LONG WHEELBASE) SEDAN</b>	<b>S 600 SEDAN</b>	<b>S 63 AMG SEDAN</b>	<b>S 65 AMG SEDAN</b>
Engine type	DOHC 24-valve V6 turbo diesel	DOHC 24-valve V6 Mild Hybrid	DOHC 32-valve Bi-turbo V8	DOHC 32-valve Bi-turbo V8	SOHC Bi-turbo 36-valve V12	DOHC 32-valve Bi-turbo V8	SOHC Bi-turbo 36-valve V12
Total displacement	2,987 cm <sup>3</sup>	3,498 cm <sup>3</sup>	4,663 cm <sup>3</sup>	4,663 cm <sup>3</sup>	5,513 cm <sup>3</sup>	5,461 cm <sup>3</sup>	5,980 cm <sup>3</sup>
Net power	240 hp @ 3,600 rpm	295 hp @ 6,000 rpm	429 hp @ 5,250 rpm	429 hp @ 5,250 rpm	510 hp @ 5,000 rpm	563 hp @ 5,500 rpm	621 hp @ 4,600-5,000 rpm
Net torque	455 lb-ft @ 1,600-2,400 rpm	284 lb-ft @ 3,000-5,000 rpm	516 lb-ft @ 1,800-3,500 rpm	516 lb-ft @ 1,800-3,500 rpm	612 lb-ft @ 1,800-3,500 rpm	664 lb-ft @ 2,250-3,750 rpm	738 lb-ft @ 2,300-4,300 rpm
Acceleration <sup>1</sup> , 0–100 km/h	7.1 seconds	7.2 seconds	5.0 seconds	5.0 seconds	4.6 seconds	4.4 seconds	4.4 seconds
Approximate top speed <sup>2</sup>	210 km/h	210 km/h	210 km/h	210 km/h	250 km/h	300 km/h	250 km/h
Tires, front rear	255/40 R 19 255/40 R 19	255/40 R 19 275/40 R 19	255/40 R 19 255/40 R 19	255/40 R 19 255/40 R 19	255/40 R 19 275/40 R 19	255/35 R 20 275/35 R 20	255/35 R 20 275/35 R 20
Fuel economy <sup>3</sup> , combined city/highway estimate	10.2-6.3 L/100 km	11.2-7.9 L/100 km	13.8-8.7 L/100 km	13.8-8.8 L/100 km	18.4-11.2 L/100 km	13.8-9.1 L/100 km	17.4-10.7 L/100km
Fuel tank capacity	83.0 L (with 11.0 L reserve)	90.0 L (with 11.0 L reserve)	83.0 L (with 11.0 L reserve)	90.0 L (with 11.0 L reserve)	90.0 L (with 11.0 L reserve)	90.0 L (with 11.0 L reserve)	90.0 L (with 11.0 L reserve)
Fuel requirement	Diesel	Premium unleaded gasoline	Premium unleaded gasoline	Premium unleaded gasoline	Premium unleaded gasoline	Premium unleaded gasoline	Premium unleaded gasoline
Dimensions <sup>4</sup>							
Wheelbase	3,165 mm	3,165 mm	3,035 mm	3,165 mm	3,165 mm	3,165 mm	3,165 mm
Overall length	5,226 mm	5,226 mm	5,096 mm	5,226 mm	5,226 mm	5,252 mm	5,252 mm
Overall height	1,479 mm	1,479 mm	1,479 mm	1,479 mm	1,479 mm	1,488 mm	1,488 mm
Overall width – (incl. mirrors)	2,120 mm	2,120 mm	2,120 mm	2,120 mm	2,120 mm	2,120 mm	2,120 mm
Curb weight	2,130 kg	2,020 kg	2,075 kg	2,095 kg	2,210 kg	2,170 kg	2,275 kg
Trunk capacity	560 litres	560 litres	560 litres	560 litres	550 litres	550 litres	550 litres

<sup>1</sup>Stated rates of acceleration are based upon manufacturer's track results and may vary depending upon model, environmental and road surface conditions, driving style, elevation and vehicle load. <sup>2</sup>Electronically limited.

<sup>3</sup>These estimates are based on the Government of Canada testing methods. The actual fuel consumption of these vehicles may vary. Refer to the Government of Canada Fuel Consumption Guide. <sup>4</sup>With standard equipment.

© 2012 Mercedes-Benz Canada Inc.

All illustrations and specifications contained in this brochure are based on the latest product information available at the time of publication. Mercedes-Benz Canada reserves the right to make changes at any time, without notice, in colours, materials, equipment, specifications and models. Any inaccuracies in colours shown are due to reproduction variations of the printing process. Some vehicles may be shown with non-Canadian equipment. Some vehicles may be shown without side marker lights. Some vehicles are shown with optional equipment available at extra cost. Some optional equipment may not be available on all models. For current information regarding the range of models, standard features, optional equipment and/or colours available in Canada and their pricing, contact your nearest authorized Mercedes-Benz dealer or visit [mercedes-benz.ca](http://mercedes-benz.ca). harman/kardon® and LOGIC7® are registered trademarks of Harman International Industries Inc. iPod® is a registered trademark of Apple Computer, Inc.

Printed in Canada  
MBC-12-S13-3975E

Mercedes-Benz Canada Inc. 98 Vanderhoof Avenue, Toronto, Ontario M4G 4C9  
1-800-387-0100  
[mercedes-benz.ca](http://mercedes-benz.ca)