

MERITOR®

MERITOR® MX-120 SERIES

FRONT DRIVE STEER AXLES, MX-10-120, MX-12-120, MX-14-120, MX-16-120, MX-18-120HR

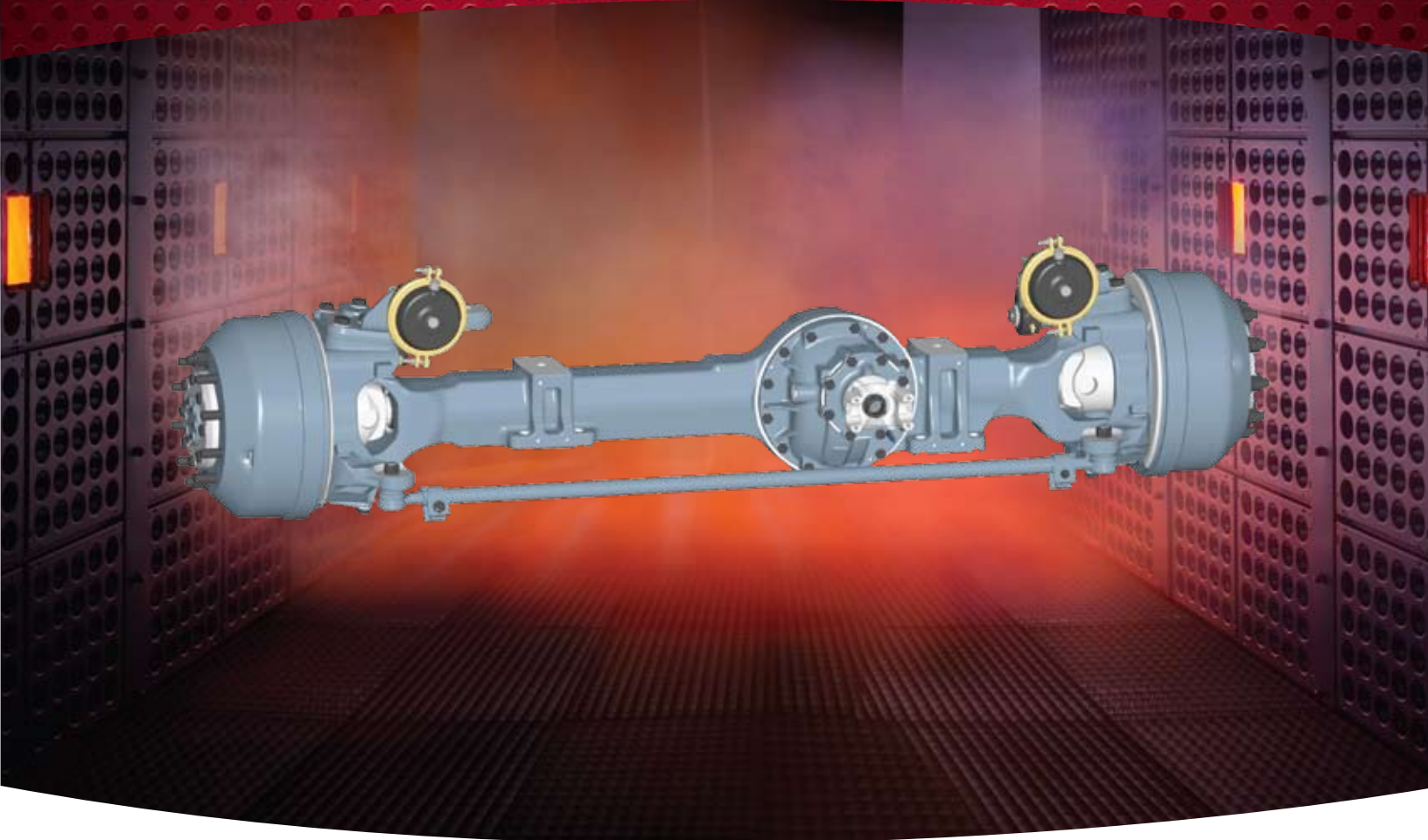

Performance Advantages:

- Meritor industry-leading differential carriers, wheel-ends, and brakes
- Easy packaging around today's engines, transmissions, and emissions hardware
- Superior turn angle and steering response
- Rugged housing and wheel-end designs for the most demanding applications
- Designed to mate with Meritor MTC-4208/10/13 transfer cases for proper input rotation and low front driveline angles

MERITOR® MX-120 SERIES

FRONT DRIVE STEER AXLES, MX-10-120, MX-12-120, MX-14-120, MX-16-120, MX-18-120HR

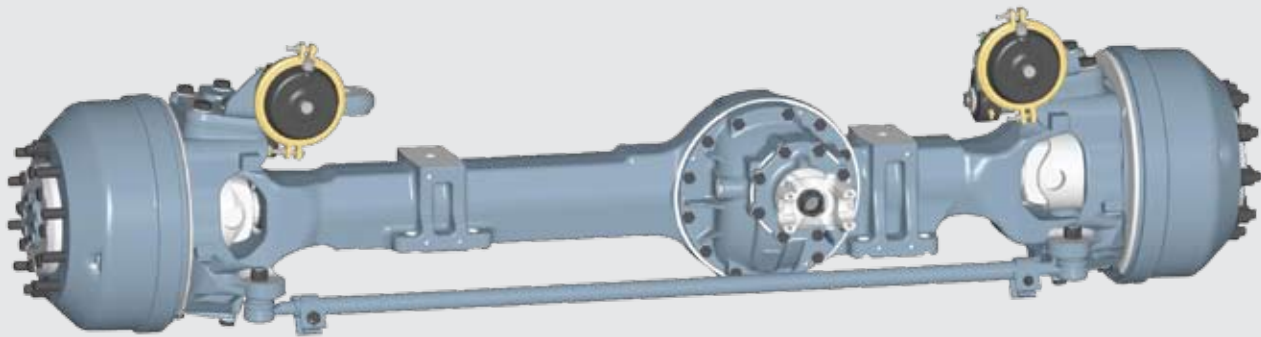

Features and Benefits:

- High offset bowl packages in most vehicle configurations without stacking frame rails
- Inverted position of Meritor's 12x global carrier loads the hypoid gearing on the stronger "drive" side
- 42-degree turn angle double cardan joints improve driver response and reduces turning radius
- 16.5" Q Plus cam brakes with outboard mounted brake drums and Meritor automatic slack adjusters
- Many options available, including the more robust 120HR carrier, limited slip differentials, 11.25" or 335mm wheel mounts, central tire inflation capable, thick walled cross tubes
- Designed to mate with Meritor MTC-4208/10/13 transfer cases for proper input rotation and low front driveline angles

MODEL	GAWR RATING* POUNDS (kg)	BRAKES TYPES AND SIZES INCHES (mm)	CHAMBER SIZE	CARRIER THRUST SCREW	RING GEAR SIZE INCHES (mm)	STANDARD RATIOS	WEIGHT** POUNDS (kg)
MX-10-120	10,000 (4535)	Q Plus™ Cam 16.5" x 5" (419 x 127)	T20L	Without	13.25 (336.55)	3.31, 3.58, 3.73, 3.91	1,872 (849.12)
MX-12-120	12,000 (5443)			With		4.10, 4.30, 4.56, 4.88	1,875 (850.48)
MX-14-120	14,000 (6350)					5.13, 5.29, 5.57, 5.86 6.14, 6.43, 6.83, 7.17	1,875 (850.48)
MX-16-120	16,000 (7257)	Q Plus™ Cam 16.5" x 6" (419 x 152)	T24L			4.33, 4.88, 5.57, 6.14, 6.83	1,880 (852.75)
MX-18-120HR	18,000 (8164)						

BOWL OFFSET INCHES (mm)	DIM OVER WHEEL INCHES (mm)	KPI INCHES (mm)	L SPRING INCHES (mm)	R SPRING INCHES (mm)	MAXIMUM OVERALL WIDTH W/STEEL WHEELS INCHES (mm)	TURN ANGLE (DEG)
10.0 (254)	94.4 (2,398)	69.0 (1,752)	16.5 (419)	20.0 (508)	98.4 (2,500)	42
10.75 (273)	95.9 (2,436)	70.5 (1,790)	16.53 (420)	20.75 (527)	99.9 (2,538)	

* All vehicle applications must be approved by ArvinMeritor engineering. Approved ratings may be higher or lower than indicated depending on vocation and engineering review. Call ArvinMeritor's Customer Service Center at 800-535-5560 for more information.

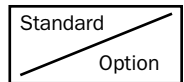

** Weights listed are for a fully-dressed axle (with brakes, hubs, drums, etc.) less lube.

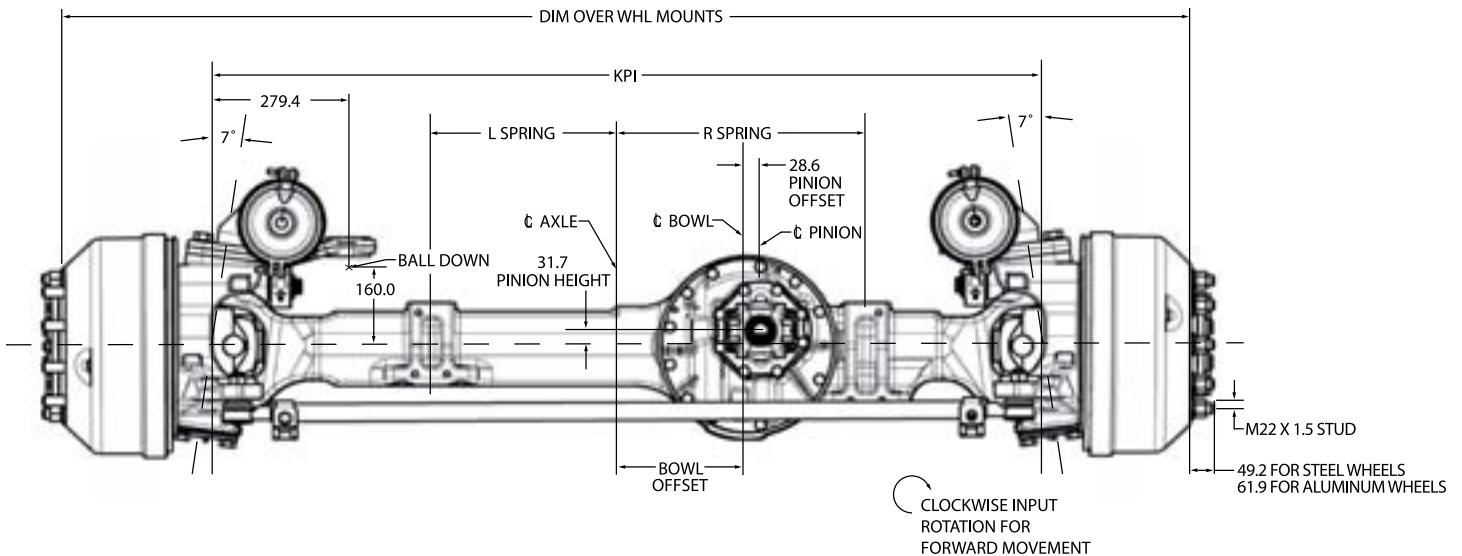



ArvinMeritor™

Meritor Heavy Vehicle Systems, LLC
2135 West Maple Road
Troy, Michigan 48084 USA
800-535-5560
www.arvinmeritor.com

Litho in USA
Revised 06-08
SP-0206 (47865/11900)
©2008 Meritor, Inc.