



JAZZ



CITY



CIVIC HATCH



CIVIC SEDAN



ACCORD



HR-V



CR-V



ODYSSEY

ODYSSEY



HONDA
The Power of Dreams



Honda Australia Pty. Ltd.
ACN 004 759 611 ABN 66 004 759 611

95 Sharps Road, Tullamarine, Victoria, 3043. Freecall 1800 804 954 honda.com.au/cars

facebook.com/HondaAustraliaCars

twitter.com/Honda_Australia

youtube.com/HondaAustralia

pinterest.com/HondaCars

instagram.com/Honda_Australia

The specifications and major features listed herein are accurate as at the date of printing (October 2015/16YM). However, Honda Australia Pty. Ltd. reserves the right to change or modify specifications and major features at any time without prior notice. Due to ordering, shipping and freight factors, some colour, model, option and accessory availabilities may vary from time to time. Check with your Honda Dealer for current information. Only Honda Genuine Accessories are made to fit Honda vehicles. The fuel consumption figures quoted in this brochure are based on ADR81/02 test results. You may experience different results depending on driving conditions and the condition of the vehicle. Honda warranties apply where due care is exercised by the owner and the vehicle is maintained in accordance with the vehicle's owner's manual. Please refer to Honda's warranty documentation for exclusions and conditions. Honda Australia Pty. Ltd. recommends careful examination of all official Honda warranty documentation before purchasing. This brochure is printed on Silk-hd. Silk-hd Gloss & Matt is produced in an ISO 14001 accredited facility ensuring all processes involved in production are of the highest environmental standards. FSC® Mixed Sources Chain of Custody (CoC) certified and well managed forests. Silk-hd is made Carbon Neutral. Odyssey VTi-L shown in Super Platinum Metallic on cover. HOD1082



The Honda Odyssey.
Made to move a crowd...
and designed to impress one.



Sleek, sexy and refined. They're not words often ascribed to a car with eight seats*. But there's no question about it – this attractive people mover is the exception to every rule. With its low lines and fine details in dazzling chrome, the all-new Odyssey is destined to turn heads.

If they're right, and it's what's on the inside that counts, nothing compares to the Odyssey. A vast cabin loaded with the latest on-road technology, and three rows of seats with space to stretch out in style.

With the intelligence to guide you into a tight park[#], double-check for traffic in a lane change[#], and even harness the full power of a 2.4L DOHC i-VTEC engine without costing the earth, the Odyssey won't be found lacking in the brains department either.

So why didn't someone think of it sooner? We did. The previous generation Honda Odyssey was named Best People Mover for five years straight, making it the most awarded car in *Drive Car of the Year* history. To do it once is clever. To do it five times in a row – it must be genetic.



*VTi model seats eight. VTi-L model seats seven. [#]Smart Parking Assist and Blind Spot Information System available on VTi-L model only. When using Smart Park Assist, always visually confirm your surroundings and take appropriate measures to avoid a crash whilst parking. Odyssey VTi-L shown in Super Platinum Metallic.

WHERE STYLE GOES, FUNCTIONALITY BOLDLY FOLLOWS.

When given the task of redesigning a car with as many accolades as the Odyssey, where do you begin? At Honda, we chose to let style lead the way. And the results are breathtaking.

From any angle, the Odyssey carves a real impression. Elegantly proportioned and perfectly streamlined, this is one people mover that leaves the box-thinking squares behind. Instead it takes a low stance on the road, broad and reassuringly solid. It's a strength echoed in every detail, from the distinctive chrome grille to the tailgate-mounted rear spoiler. Running the length of the vehicle you'll discover a sophisticated chrome belt line, accentuated by alloy

wheels that appear to be urging the Odyssey forward even before the engine starts.

And when it does, so too do the stunning LED Daytime Running Lights, which emphasise the slim, angular shape of the headlights. LED 'light guide' taillights produce a similar effect for vehicles following behind. On the VTi-L model, you can expect lighting technologies that are even more advanced. LED projector beams light the path ahead, while intelligent Active Cornering Lights (ACL) help you see around corners. So no matter where your journey takes you, you can count on the illumination it provides.



Odyssey VTi-L shown in Premium Twinkle Black Pearlescent.



Room for growing legs.
And growing families.

Because everyone needs their space, the Odyssey has plenty. Leg room, head room, and even hip room has been generously afforded. By giving the cabin extra height and width, as well as a surprisingly low floor, Honda has created a car your family won't outgrow.

In fact, the increased width means the Odyssey VTi can comfortably make room for up to eight passengers, with the option of converting the 2nd-row centre seat into an armrest to keep restless little passengers at bay on a long road trip. Such a voyage is the specialty of the 7-seat VTi-L, which hosts two very indulgent captain's chairs in the second row. These seats are designed to slide together for enhanced access to the third row, or apart to create a handy centre aisle.

It's even possible to fold away the entire rear row and slide the captain's chairs all the way back to transform this cosy cabin into something more like a living room. Simply sit back, recline, and put your feet up on the comfortable ottoman footrests.

But there's more to luxury than space alone. And that's why Honda has taken care to only include features and fabrics that meet its high expectations of quality: distinguished accents in a woodgrain-look, sleek contemporary fabric in the VTi, and exquisitely stitched leather* seats in the VTi-L model.

Both VTi-L front seats can be heated in colder weather, while the most important seat – yours – offers complete 8-way power adjustment with the flick of a switch.

*Leather seat trim includes non-leather material on selected, high impact surfaces.

Odyssey VTi-L shown.



CHANGES AS QUICKLY AS YOUR FAMILY DOES.

One moment you're loading them into baby seats, the next they're borrowing the car for a surf expedition to the coast. Family life never stops – that's what makes it so rewarding.

Whichever stage your family is at, the Odyssey has the perfect seat configuration. In a few easy movements, the car can be converted from an 8-seater* to a 5-seater*, or even a 2-seater. It's thanks to the 40/20/40 split-fold third-row seats, which can be folded away into an under-floor cavity to create a cavernous cargo area. In the VTi model, each of the second-row seatbacks can fold down independently for maximum versatility.

There's no shortage of storage for those smaller items, either. Handy compartments above and below the instrument panel keep your necessities in easy reach, while maps and magazines can be slipped away into the seat pockets and recessed front door panels. With a discreetly positioned glovebox, your most precious items are secure.

The lowered floor makes stepping in and out of the Odyssey easier than ever. And with a tailgate opening low from the ground, unpacking a full load of luggage or sports equipment is practically a pleasure.

*In the VTi model only.

Main: VTi shown. Inset: VTi-L shown.



A cockpit that knows exactly who's in charge.

For a car that's packed with advanced technology, one of the most impressive things about the Odyssey is how simple it is to operate. You might put that down to the cleanly arranged dashboard, which keeps the most important information in direct sight. Even the Multi Information Display (MID), which keeps a log of things like fuel economy, distance to empty, and average speed, is just a touch away.

Built into the elegant four-spoke leather-wrapped steering wheel are buttons

for audio, cruise control, and connected Bluetooth devices, while your central 7-inch touch-activated colour screen takes care of the rest. On this screen you'll find the display for your multi-angle reversing camera, as well as a menu system to provide easy access to music, calls, and many of the other things you love about your smartphone*. You can even watch a video or view your photo album while waiting for the kids#. The VTI-L also utilises the touchscreen for its built-in

Satellite Navigation system with live SUNA^ traffic updates working to avoid congestion and potential traffic hazards.

The brilliance of the cockpit doesn't stop there. With heated front seats, heated door mirrors and automatic headlights seamlessly integrated in the design, you will enjoy the luxury of controlling everything with ease. And with the driver's seat positioned high in the cabin for ultimate control and visibility, there's no doubt about who's in charge.

*VTi-L model only. *Requires compatible Bluetooth device. Compatibility and functionality will vary depending on the device. *Compatible with iPhone 5 (running iOS7) or newer. Operates only while the vehicle is stationary. Requires HDMI cable, Apple-approved lightning cable and Digital AV adapter (these items may be purchased separately from your Honda Dealer). Apple and iPhone are trademarks of Apple Inc., registered in the U.S. and other countries. HDMI is a registered trademark of HDMI Licensing LLC in the United States and other countries. IOS is a trademark of Cisco in the U.S. and is used under licence. All other trademarks are properties of their respective owners. #SUNA is a registered trademark of Intelematics Pty Ltd. Coverage includes Melbourne, Sydney, Brisbane, Gold Coast, Adelaide, Perth and Canberra metropolitan areas. Refer to sunattraffic.com.au for full details. The Bluetooth word mark is owned by Bluetooth SIG, Inc. and use of such mark by Honda is under licence.



Display Audio – Odyssey VTi-L shown

Stay connected with the Odyssey's impressive Display Audio system.

Change the music. Answer a call*. Hear a text message†. Watch video‡ content when your car is stationary and even check live SUNA† traffic updates with Satellite Navigation on the VTi-L model. The Display Audio system brings the power of a smartphone to the 7-inch colour screen at the heart of your Honda Odyssey. With a tap, pinch or swipe, you're in full command. You can also use the steering wheel-mounted controls or hands-free Siri voice commands‡. So wherever the Odyssey takes you, the sounds and features you love are just a swipe away.



Bluetooth® controls*



USB port



Multimedia audio system

There's nothing like the perfect tune to complement a beautiful drive. With a CD player, USB ports and HDMI® port‡, plus Bluetooth® audio streaming‡, all the Odyssey requires of you is to select a song for the journey. Of course, if you prefer surprises, you can always tune in to your favourite station with the AM/FM radio.



USB/HDMI port*

The Display Audio system makes browsing any audio library a breeze. With your compatible smartphone or MP3 media device* plugged into the USB port, you can view the song title, artist, and even album art if this information is available. Scroll through your playlists right there on screen, or use the steering wheel-mounted controls. The display will even project your iPhone through the Honda Cable Kit whilst your Odyssey is in park mode.



Navigation

In the VTi-L model, you'll find Satellite Navigation right there on the 7-inch colour screen. Using live SUNA† traffic updates, your car will know where it's heading, what the best route is and how the traffic situation is looking.



Handsfree connectivity

Your compatible smartphone and the Odyssey make the perfect pair with Bluetooth® and Siri‡. Bluetooth® connectivity* allows you to take calls while you keep your hands on the wheel and even make calls using pre-assigned voice-tags. With Siri‡, you can press the voice command button on the steering wheel and ask Siri to call someone on your contacts list, play that song, read and compose text messages or emails, and more. All while your eyes remain on the road.

WMA

MP3

MP4

Bluetooth®

HDMI®
HIGH-DEFINITION MULTIMEDIA INTERFACE

*Requires compatible Bluetooth device. Compatibility and functionality will vary depending on the device. †Requires compatible iOS7 device (iPhone® 4S or newer). ‡Compatible with iPhone 5 (running iOS7) or newer. Operates only while the vehicle is stationary. Requires HDMI cable, Apple-approved lightning cable and Digital AV adapter (these items may be purchased separately from your Honda Dealer). Apple, iPhone, iPod and Siri are trademarks of Apple Inc., registered in the U.S. and other countries. HDMI is a registered trademark of HDMI Licensing LLC in the United States and other countries. IOS is a trademark of Cisco in the U.S. and is used under licence. All other trademarks are properties of their respective owners. †SUNA is a registered trademark of Intelmatics Pty Ltd. Coverage includes Melbourne, Sydney, Brisbane, Gold Coast, Adelaide, Perth and Canberra metropolitan areas. Refer to sunattraffic.com.au for full details. The Bluetooth word mark is owned by Bluetooth SIG, Inc. and use of such mark by Honda is under licence.

Multi-view camera.



Activate

Odyssey VTi-L shown.

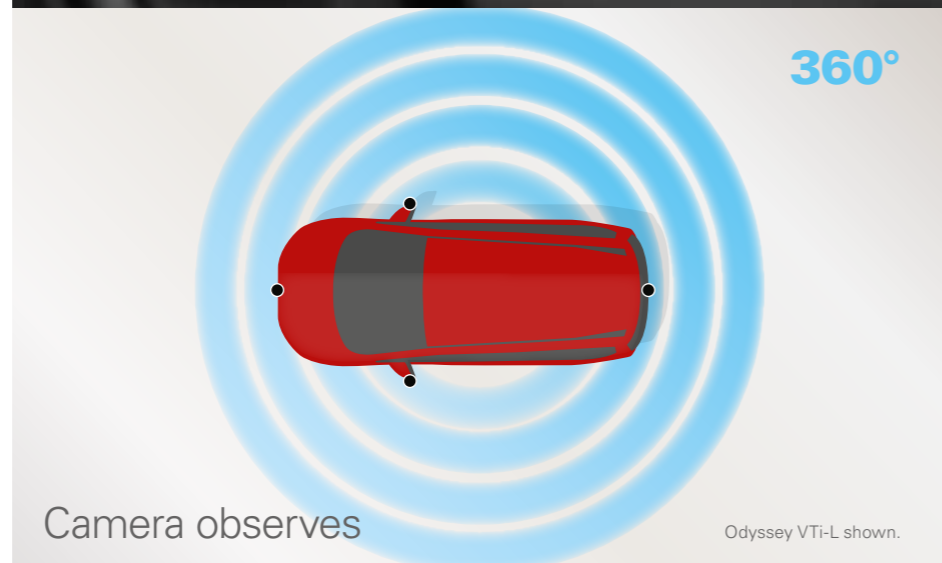

Camera observes

Odyssey VTi-L shown.



View on screen

Odyssey VTi-L shown.



View on screen

Odyssey VTi-L shown.

Smile, because the Odyssey has you covered. The VTi puts its multi-angle reversing camera[^] at your service, while the VTi-L features four cameras mounted around the car to provide an impressive 360° panoramic view. Simply touch the central screen or press a button on the indicator stalk to engage the camera or switch between views for astonishing visibility.

With up to six views to choose from (including front, side, rear and top-down) and guidance lines to plot your projected path, this very clever multi-view camera is your new best friend in the face of blind spots or tight spots.



One-touch power sliding doors

Because you only have so many hands, the Odyssey is smart enough to open the door for you. Power sliding doors (on both sides of the VTi-L and one side of the VTi model) open automatically with a slight pull of the door handle or press of the remote key fob. You can even open the door from the dashboard for a lightning-fast after school pick up.



Hydrophilic and heated wing mirrors

When wing mirrors are frosted over or obscured by raindrops, they're not doing their job. The Odyssey's hydrophilic door mirrors ward off droplets to maintain visibility, while the handy heating system keeps the glass crystal clear and fog-free.



Conversation mirror

With a view of the entire cabin the Odyssey minimises blind spots inside too. Your front seat passenger can keep an eye on the special little passenger in the baby seat or catch up with your rear seat passengers using the conversation mirror.



Electrostatic touch-based climate control panel

Conduct the interior climate from the front seat with the impressive button-free electrostatic dual-zone climate control. With an up or down swipe of the finger over the panel you can pinpoint your perfect cruising temperature, one degree at a time. Just like magic.



Tri-zone climate control*

Keeping the peace is easy in the VTi-L model, which allows rear seat passengers to independently adjust fan and temperature settings to take control of their own climate. Now your backseat passengers are just as happy as the ones up front.



Auto-dimming rear-view mirror*

For safer driving at night, the electrochromatic rear-view mirror automatically dims to reduce headlight glare from vehicles following close behind.



Smart keyless entry*

The Odyssey can even sense your approach. Leave the key fob safely in your pocket or bag and the doors will automatically unlock when you touch the front door handles or press the tailgate release button.



Push button start*

When the key fob is within range, the Odyssey comes to life at the push of a button. Just press your foot on the brake pedal and hit start. To turn the car off, simply hit the button again.



Rear sunshade*

Back seat glare is no match for the VTi-L, with pull-up sunshades on the 2nd row windows to provide superior protection and shade for the rear of the cabin.



Sunroof*

With a single touch, the electric sunroof of the VTi-L opens with tilt and slide functionality. A floating liner gives you additional control over the level of light shining down onto your passengers.



Heated seats*

It's the small touches that make the Odyssey a pleasure to drive. The luxurious leather-appointed[†] front seats in the VTi-L can be individually adjusted for extra warmth when the winter weather arrives.



Power adjustable front seats*

With an 8-way power adjustment, the driver's seat in the VTi-L makes it easy to find your perfect driving position. Even the front passenger seat comes with 4-way power adjustment for total comfort.

[^]Multi-view camera is a driver assist technology and should not be used in place of safe driving practices. Drivers should continue to check their surroundings when manoeuvring the vehicle at all times. *VTi-L model only. [†]Leather seat trim includes non-leather material on selected, high impact surfaces.

The Odyssey's engine – with great power comes great handling.



The Odyssey may be made to carry up to eight passengers[#], but with the agility of a small car, outstanding fuel economy of 7.6L/100km* and elements of Honda's Earth Dreams Technology, you'll never feel like you're driving a bus.

It's not just its sleek proportions that make the Odyssey a rebel in its class. At the heart of this car lies an impressive 2.4L DOHC i-VTEC engine, with enough power for a quick cross-town jaunt or a full-on cross-country trip with the family in tow. The Odyssey generates an impressive 225Nm of torque and 129kW of pure power, making every little errand a pleasure to run.

Part of the appeal is the newly developed Continuously Variable Transmission (CVT). Designed to ensure the throttle responds fluently when you push the accelerator, the result is exhilarating acceleration and a smoother, more natural driving feel. What's more, by always having the right ratio to call on, the CVT offers better fuel economy than conventional automatic transmissions.

For more performance-orientated driving, simply switch into S-mode and take manual control of seven fixed gear ratios with steering wheel mounted paddle shifters at your fingertips.

EARTH DREAMS
TECHNOLOGY



VTi-L model shown.

Idle Stop

In optimum conditions, Idle Stop[^] technology automatically switches off the engine when you come to a standstill, like at traffic lights. It re-starts automatically when you take your foot off the brake, saving fuel and reducing emissions.

Eco Assist

Advanced technology is only part of getting good fuel economy numbers. The other side of the equation is the person in the driver's seat.

Imagine a driving coach that helps you to drive more efficiently – and makes it fun. Eco Assist is a visual training system that responds to your drive. Brake or accelerate heavily and the Odyssey's speedometer glows white. Keep it smooth and under control and you'll be rewarded with an encouraging green glow.

ECON Mode

Engage the green button and Odyssey does exactly what you might expect, adjusting engine behaviour, transmission and air conditioning to maximise fuel economy.

The handling of a smaller car

There's one more way in which the Odyssey defies its size and that's through its remarkable level of agility. If you're used to a car with sporty, responsive handling, you won't find anything amiss here. That's thanks largely to the all-new Electric Power Steering (EPS) and suspension technology. Combining MacPherson struts at the front and new Amplitude Reactive Dampers in the rear, the Odyssey provides a perfect balance between superior ride comfort, and crisp, precise handling.

So how does it perform under pressure – in the supermarket carpark for example? Even in that great testing ground for any long vehicle, the Odyssey runs circles around the competition. Tiny circles. Because at just 10.8 metres, this car's turning circle rivals even the Honda Civic Sedan.



[#]VTi model seats eight.
^{*}The figure quoted is based on ADR81/02 combined test results for Odyssey VTi.
[^]Idle Stop may not activate during certain operating and environmental conditions. Refer to Owners Manual for details.

HONDA IS COMMITTED TO DESIGNING EVERY MODEL WITH EXCEPTIONAL SAFETY FEATURES. WE EVEN BUILT THE WORLD'S LARGEST OMNI-DIRECTIONAL CRASH FACILITY TO TEST OUR CARS MORE THOROUGHLY.

Multi-angle reversing camera

Each model has a reversing camera as standard, so you'll feel just as safe going backwards as you do going forwards.

Emergency Stop Signal (ESS)

If an emergency situation forces you to brake heavily, drivers behind you need as much warning as possible. Emergency Stop Signal does just that, automatically flashing the hazard lights in the event of hard braking to reduce the chance of a rear-end collision.

Tyre Deflation Warning System (DWS)

This clever technology detects and alerts you to an abnormal decrease in tyre pressure.

Hill Start Assist (HSA)

Hill Start Assist prevents 'roll back' when starting on an incline. The system controls brake pressure, keeping the car stationary for a moment after you release the brake pedal.

Vehicle Stability Assist (VSA) with Traction Control

This technology helps keep the Odyssey on course in adverse driving conditions by detecting, then mitigating, potential understeer or oversteer. When necessary, VSA automatically reduces engine power and manages brake pressure to individual wheels to help regain control.

Child seat anchors

The Odyssey gives you child seat anchorages for the 2nd and 3rd row seats, because when you've got kids on board, it's good to be flexible.

Whiplash mitigating front seats

In the event of a collision, the seatback springs are optimised so that the seat will more equally absorb the occupant's impact, in a manner that can minimise the severity of a whiplash injury.

Airbags

The clever Honda i-SRS driver airbag system inflates at different rates depending on crash severity, seatbelt usage and a host of other factors to keep you safe behind the wheel. Dual front, side and full-length curtain airbags are standard.

Advanced Compatibility Engineering (ACE)

The Odyssey has been designed with an innovative body structure, engineered to absorb and deflect the force of a frontal collision away from the passenger compartment, improving the safety of every occupant.

Pedestrian protection

Research has proven that sophisticated protection features, like windscreen wiper pivots that break away on impact and energy absorbing front guard mounts, dramatically improve a pedestrian's chance of survival if struck. So naturally they come standard on the Odyssey.

Daytime Running Lights

LED Daytime Running Lights don't just look great, they provide increased car visibility too.

ABS, EBD and Brake Assist

When emergency braking is detected, Brake Assist (BA) applies maximum braking pressure, activating the Anti-lock Braking System. ABS helps stop the wheels locking under heavy braking, allowing you to maintain steering control whilst Electronic Brake-force Distribution (EBD) balances the front-to-rear braking distribution according to vehicle loading.

Active Cornering Lights (ACL)*

The Odyssey VTi-L's headlights feature side lamps on either side that illuminate the direction in which you are turning, thereby reducing blindspots and helping bring potential hazards to light sooner.

Automatic tensioning seatbelts

Because there's no cargo more precious than the people you love, the moment you're involved in a collision, the same sensors that deploy the Odyssey's airbags automatically retract the front seatbelts. You and your passenger are instantly pressed back safely into your seats.

With its 5-star ANCAP safety rating, the highest possible assessment, the Odyssey is one of the safest drives on the market.



*VTi-L model only. Odyssey VTi-L shown in Super Platinum Metallic.

SO SMART ABOUT SAFETY YOU'D BE HAPPY FOR THE KIDS TO DRIVE IT. ONE DAY.

With the whole family onboard, assurances of safety are more important than ever. Knowing this, Honda has equipped the Odyssey with an extraordinary range of safety features – technology designed to help you sense and react to hazards, avoid collisions, and instill you with confidence no matter what the driving conditions. Here are just a few of the remarkable technologies inside the VTi-L model.



Odyssey VTi-L shown in Premium Twinkle Black Pearlescent.

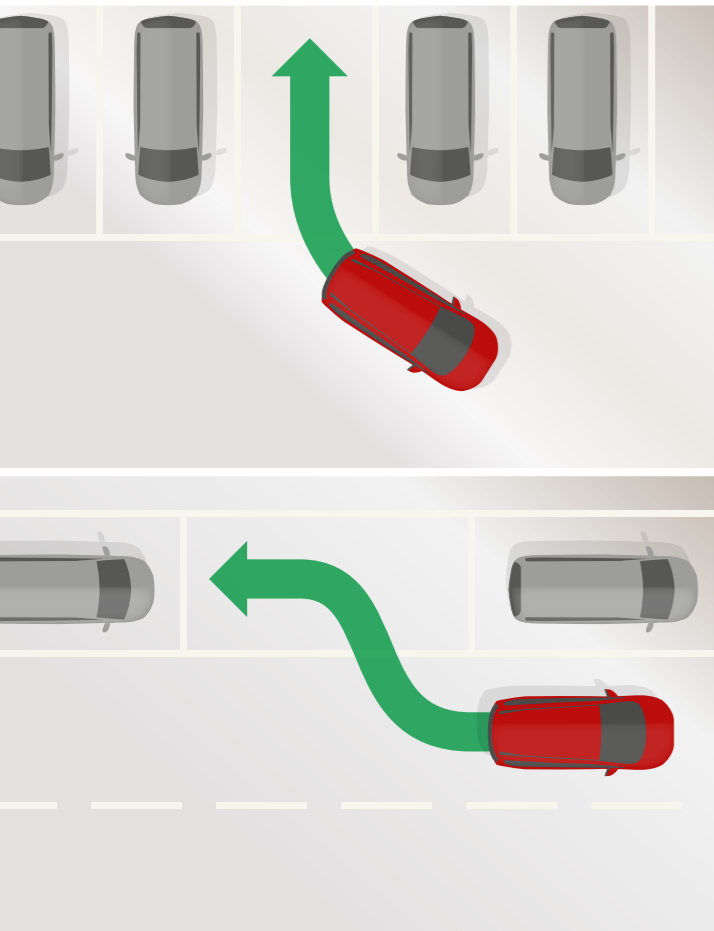

Smart Parking Assist System*

The greatest challenge of a larger car can be getting used to parking it. Not in the Odyssey VTi-L, which will help guide you into even the tightest of parks. When you've found an available space, the Odyssey's Smart Parking Assist System takes action and the car virtually reverse parks itself. With just a couple of actions (to ease back and forward on command) the Odyssey automatically steers into any standard right angle or parallel space for a park that would impress the best.

What's more, the multi-view camera display acts as your second pair of eyes, providing an all-round view as you go so you'll always feel in control.

Cross Traffic Monitor*

Wouldn't it be nice to see past those giant SUVs in the supermarket carpark? Now you can reverse out into the street with confidence. The Cross Traffic Monitor detects oncoming traffic on either side, and alerts you via an audible warning and multi-view camera display. It's clever thinking at its most practical.

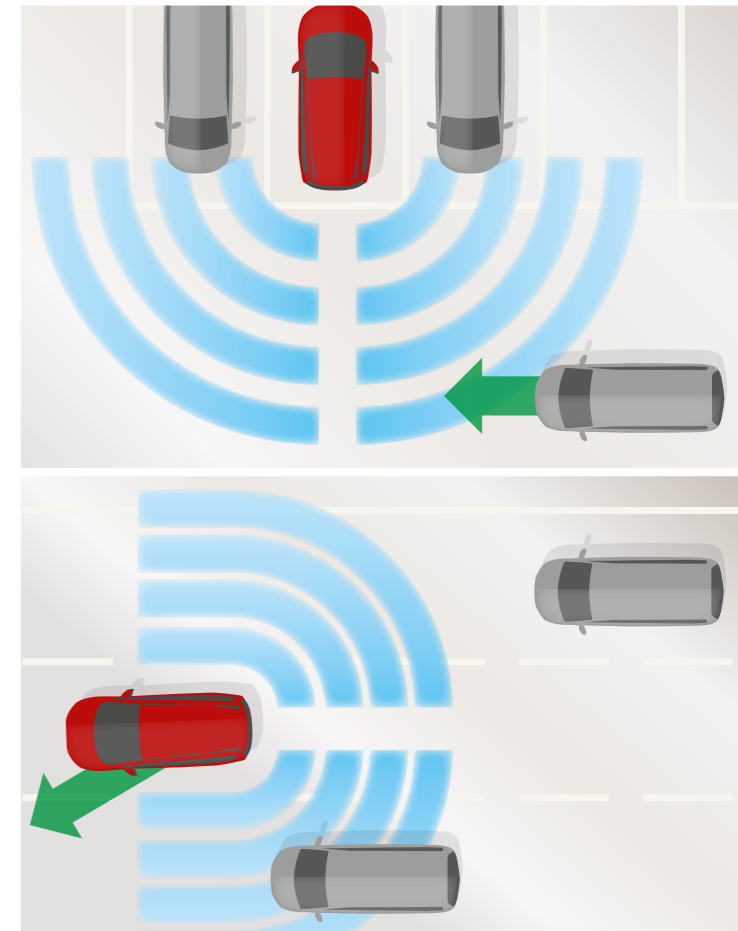

Blind Spot Information System*

You've checked your mirror, but before you change lanes why not let the Odyssey check one more time? If the radar detects an object in your left or right side blind spots and you indicate to change lanes in its direction, you'll be instantly notified with a flashing icon in the door mirror and a warning sound. How's that for safe?

*VTi-L model only. Smart Parking Assist, Cross Traffic Monitor and Blind Spot Information System are driver assist technologies and should not be used in place of safe driving practices. Drivers should continue to monitor the road ahead and take care when manoeuvring the vehicle at all times.

Select your model and colour.



VTi

The Odyssey VTi comes standard with:

- 2.4 litre DOHC i-VTEC 4 cylinder engine with auto idle stop
- Automatic CVT transmission (with paddle shifters)
- Motion Adaptive Electric Power Steering (MAEPS)
- 17-inch alloy wheels
- Electrically retractable and heated door mirrors
- Dusk-sensing projector-beam halogen headlights
- LED Daytime Running Lights (DRL)
- LED light guide taillights
- One-touch power sliding rear door (passenger-side)
- Eight seats (2nd row with 3-seater bench)
- Dual-zone climate control with rear fan speed control panel
- Rear cooling ventilation (ceiling vents)
- Fabric seat trim
- Leather-wrapped steering wheel
- Multi-angle reversing camera
- Power windows with one-touch auto up/down (driver)
- 3rd row 40/20/40 split fold seats
- Display Audio including:
 - 7-inch full-colour touchscreen
 - AM/FM radio and CD player (MP3 compatible^o)
 - Bluetooth[®] phone and audio connectivity^o
 - Siri Eyes Free⁺ mode
 - USB port
 - HDMI port[#]
- SRS airbags: dual front, side and full-length curtain
- Advanced Compatibility Engineering (ACE)
- Security alarm and immobiliser
- Tyre Deflation Warning System (DWS)
- Vehicle Stability Assist (VSA) with Traction Control
- Whiplash mitigating front seats
- Hill Start Assist (HSA)



VTi-L

Additional features over the Odyssey VTi:

- 17-inch alloy wheels (two-tone)
- Aero styling
- LED projector-beam headlights
- LED Active Cornering Lights (ACL)
- Front fog lights
- LED rear door puddle light
- Electric sunroof
- Smart entry and push button start
- Seven seats only (2nd row with 2x captain's chairs)
- Auto-dimming rear-view mirror
- Tri-zone climate control with independent rear control
- Rear ventilation (3rd-row floor vents)
- Leather-appointed seat trim[^]
- Heated front seats
- 8-way power adjustable driver seat
- 4-way power adjustable front passenger seat
- One-touch power sliding rear door
- All windows with one-touch auto up/down
- Roll-up sunshades (2nd row)
- Display Audio with built in navigation (DA+ with SUNA[†] traffic updates)
- Blind Spot Information System
- Cross Traffic Monitor
- Multi-view camera system
- Smart Parking Assist



Trims



VTi – 8 seats



VTi-L – 7 seats

Colours

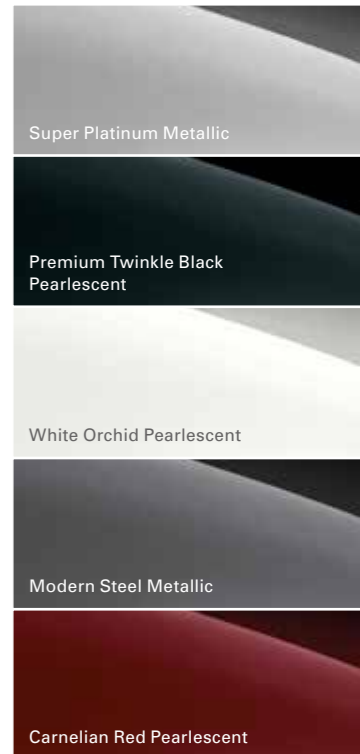

Requires compatible Bluetooth device.
^oCompatibility and functionality will vary depending on the device.
⁺Requires compatible iOS7 device (iPhone[®] 4S or newer).
[#]Compatible with iPhone 5 (running iOS 7) or newer. Operates only while the vehicle is stationary. Requires HDMI cable, Apple-approved lightning cable and Digital AV adapter (these items may be purchased separately from your Honda Dealer).
 Apple, iPhone and Siri are trademarks of Apple Inc., registered in the U.S. and other countries. HDMI is a registered trademark of HDMI Licensing LLC in the United States and other countries. IOS is a trademark of Cisco in the U.S. and is used under licence. All other trademarks are properties of their respective owners.
[^]Leather seat trim includes non-leather material on selected, high impact surfaces.
[†]SUNA is a registered trademark of Intelematics Pty Ltd. Coverage includes Melbourne, Sydney, Brisbane, Gold Coast, Adelaide, Perth and Canberra metropolitan areas. Refer to sunattraffic.com.au for full details. The Bluetooth word mark is owned by Bluetooth SIG, Inc. and use of such mark by Honda is under licence.



Deluxe tailored mats.



Door switch panel set – front and rear.



Door lining illumination set.



Accent lighting – front and 2nd row.



Front grille – piano black.



Door visor set.



Rear park assist.



Mud guard set (VTi-L design shown).



Camping tent – sleeps 6 people.



Door sill garnish set – illuminated.



Rear bumper and bootlip protector.



Luggage area protector tray.



Luggage area protector mat.



Cargo upper cover.



Cargo net.

PRACTICAL ADDITIONS, BEAUTIFULLY DESIGNED.

Countless hours of thought were invested in delivering the Honda Odyssey, whose looks are as beautiful as its performance. To help keep it looking its best, there's a range of Honda Genuine Accessories to protect against damage and enhance the car's looks both inside and out. And because the Odyssey is not just for show, there's also a host of practical additions that will have you ready to carry and store with absolute ease.

Other accessories include:

- Bonnet protector
- Headlight protector set
- Honda Cable Kit
- Leather maintenance kit
- Touch-up paint
- Wheel lock nut set

See your Honda Dealer for advice regarding Honda Genuine Accessories. Pictured accessories are all sold separately. All Honda Genuine Accessories installed at the time of retail sale of a new motor vehicle are covered by Honda's 3-year/100,000km Warranty. If installed after retail sale, they are covered for the remainder of the warranty or a minimum of 12 months – whichever is greater – provided that the accessory is fitted only to the vehicle for which it was intended by Honda Motor Co. *CR-V model shown for illustrative purposes.

Odyssey Specifications

Description	VTi	VTi-L
ENGINE		
Engine type	– In-line 4 cylinder i-VTEC	•
Engine capacity	– 2.4 litre – 2356cc	•
Valve train	– DOHC 16 valve	•
Compression ratio	10.1	10.1
Bore x Stroke (mm)	87 x 99.1	87 x 99.1
Fuel supply system	– Honda Programmed Fuel Injection (PGM-FI)	•
Fuel type (minimum recommended)	– Unleaded (RON91)	•
Drive By Wire throttle (DBW)	•	•
Auto idle stop	– on/off switch	•
TRANSMISSION		
Continuously Variable Transmission (CVT) with:	– paddle shifters	•
	– transmission shift lock	•
PERFORMANCE AND FUEL ECONOMY		
Maximum power (kW @ rpm)	129 @ 6200	129 @ 6200
Maximum torque (Nm @ rpm)	225 @ 4000	225 @ 4000
Fuel consumption (litres/100km)*	– combined	7.6
	– urban	9.4
	– extra urban	6.6
CO2 emissions (g/km)*	– combined	178
Emission standard	– ADR79/04 (Euro 5)	•
CHASSIS		
Monocoque body construction	•	•
Suspension type	– MacPherson strut (front)	•
	– Torsion beam	•
Steering type	– Motion Adaptive Electric Power Steering (MAEPS)	•
Brakes	– Ventilated disc (front)	•
	– Solid disc (rear)	•
EXTERIOR		
Aero styling	– front and rear bumpers, side skirts and sports grille	–
Antenna	– in-glass type	•
Door handles	– chrome	•
Electrically adjustable door mirrors with:	– LED turn indicators	•
	– electrically retractable	•
	– heating function	•
	– hydrophilic mirror	•
Electric sunroof (with remote key fob operation)	–	•
Rear roofline spoiler with integrated brake light	•	•
Rear window demister	•	•
Windows	– acoustic windscreen	•
Wipers (front) with:	– 2-speed with variable intermittent function	•
Wipers (rear) with:	– Intermittent with reverse gear synchronisation	•
EXTERIOR LIGHTS		
Fog lights	– front	•
Headlight type	– halogen projector beam	–
	– LED projector beam	•
Headlights with:	– auto off (coming/leaving home function)	•
	– auto on/off (dusk-sensing)	•
	– LED Active Cornering Lights (ACL)	–
	– LED Daytime Running Lights (DRL)	•
LED rear door puddle light	–	•
LED high mounted brake light	•	•
LED light guide taillights	•	•
DRIVER AIDS		
Cruise control	•	•
Eco Assist and ECON Mode	•	•
Multi-function steering wheel controls	•	•
Multi Information Display (MID)	•	•
Tachometer	•	•
COMFORT AND CONVENIENCE		
Air conditioning (dual-zone climate control)	– with rear cooling	•
Air conditioning (tri-zone climate control)	– with independent rear control	–
Rear air conditioning vents	– 2nd and 3rd row ceiling vents	•
	– 3rd row floor vents	–
Conversation mirror	•	•
Grab handle	– ceiling-mounted	•
	– centre pillar-mounted	•
Interior illumination	– LED map lights	•
	– LED cabin lights	•
	– front door courtesy lights	•
	– luggage area light	•
	– vanity mirror light (front)	•
Key type	– remote keyless entry	•
	– smart keyless entry with push button start	–
One-touch power sliding rear door	– passenger side	•
	– driver side	–
	– automatic operation via dashboard and key fob	•
Park brake type	– foot type	•
Power windows	– one touch auto up/down function (driver)	•
	– one touch auto up/down function (all)	–
	– remote key fob operation	•
Rear-view mirror	– day/night type	•
	– auto-dimming	–
Roll up sunshades	– 2nd row	•
Illuminated sunvisor vanity mirror	– front	•
Tilt and telescopic adjustable steering wheel	•	•
SEATING		
Front row	– heating function	–
	– driver seat manual height adjustment	•
	– driver seat power adjustment (8-way)	–
	– passenger seat power adjustment (4-way)	•
Second row (3-seater bench)	– 40 / 20 / 40 split-fold backrest	•
	– centre fold-down armrest with two cup-holders	•
	– recline and slide functionality	–
Second row (2 captain's chairs)	– adjustable armrests and ottomans	–
	– recline and long slide functionality (slide front to rear and side to side)	–
Third row:	– recline functionality	•
	– 40 / 20 / 40 split-fold seats (folds flat into underfloor recess)	•

Odyssey Specifications

Description	VTi	VTi-L
Adjustable head restraints	– all seats	•
Seat trim material	– fabric	–
	– leather-appointed [^]	•
INTERIOR STYLING		
Leather-wrapped steering wheel	•	•
Instrument panel inlay	– brown woodgrain effect	–
	– black woodgrain effect	•
STORAGE		
Coat hook (x1)	•	•
Bottle holders	10	8
Door pockets	– front	•
Centre console lift up tray with two cup holders	•	•
Glovebox (with soft opening)	•	•
Luggage area storage compartment	•	•
Seat back pocket (x2)	•	•
Sunglass holder	•	•
Sunvisor ticket holder (driver-side only)	•	•
MULTIMEDIA		
Accessory power outlet (12V)	– front and rear	•
Display Audio featuring:	– 7-inch full-colour capacitive touchscreen	•
	– Bluetooth® phone and audio streaming [†]	•
	– built-in navigation with SUNA ¹ live traffic updates	–
	– customisable wallpaper	•
	– Siri Eyes Free [†] mode	•
	– MP4 movie file play [#]	•
	– vehicle information (fuel economy, trip computer)	•
6 speaker audio system	– 4 speakers, 2 front tweeters	•
AM/FM radio	•	•
CD player, single disc (MP3/WMA compatible)	•	•
HDMI port [#]	•	•
USB port (x2)	•	•
Speed-sensitive Volume Compensation (SVC)	•	•
SAFETY RATING		
5-star ANCAP	•	•
ACTIVE SAFETY		
Anti-lock Braking System (ABS)	•	•
Electronic Brake-force Distribution (EBD)	•	•
Brake Assist System (BA)	•	•
Emergency Stop Signal (ESS)	•	•
Blind spot information system	–	•
Tyre Deflation Warning System (DWS)	•	•
Vehicle Stability Assist (VSA)	•	•
Traction Control System (TCS)	•	•
Hill Start Assist (HSA)	•	•
PASSIVE SAFETY		
Advanced Compatibility Engineering (ACE) structure	•	•
SRS airbags	– front (with driver dual-stage inflation)	•
	– side	•
	– full-length curtain (all three rows)	•
Child-proof rear door locks	•	•
Child safety seat anchorage points	– second and third row seats	•
Seatbelt reminder	– front	•
Seatbelts (3 point)	– height adjustable (front)	•
	– pre-tensioner and load limiter (front)	•
	– Automatic Locking Retractors (ALR) - centre row	•
	– Emergency Locking Retractors (ELR) - all seats	•
Side impact protection	•	•
Whiplash mitigating front seats	•	•
PARKING AIDS		
Multi-angle reversing camera	– normal, wide, top-down	•
Multi-view camera system	– front, side, rear, 360° top-down	–
Smart Parking Assist (SPA)	–	•
Cross Traffic Monitor (CTM)	–	•
SECURITY		
Engine immobiliser	•	•
Security alarm system	•	•
Remote central locking	•	•
Remote keyless entry	•	•
Smart keyless entry and push button start	–	•
DIMENSIONS		
Overall length (mm)	4840	4840
Overall width (mm)	1800	1820
Overall height (mm)	1695	1695
Wheelbase (mm)	2900	2900
Track – front and rear (mm)	1560	1560
Ground clearance - unladen (mm)	150	150
Minimum turning radius at wheel centre (m)	5.4	5.4
WEIGHTS AND CAPACITIES		
Fuel tank capacity (L)	55	55
Maximum permissible weight (kg)	2450	2450
Tare mass (kg)	1727	1817
Seating capacity	8	7
WHEELS AND TYRES		
Wheel size	17x7 J	17x7 J
Tyre size	215/55R17 98V	215/55R17 98V
Alloy wheel	•	•
Temporary spare wheel	•	•

• Standard feature. – Not available. *The figures quoted are based on ADR81/02 test results. [^]Leather trim includes some non-leather materials in selected high impact areas. [†]Requires compatible Bluetooth device. Compatibility and functionality will vary depending on the device. ¹SUNA is a registered trademark of Intelematics Pty Ltd. Coverage includes Melbourne, Sydney, Brisbane, Gold Coast, Adelaide, Perth and Canberra metropolitan areas. Refer to sunatrafic.com.au for full details. [†]Requires compatible iOS7 device (iPhone® 4S or newer). [#]Compatible with iPhone 5 (running iOS7) or newer. Operates only while the vehicle is stationary. Requires HDMI cable, Apple-approved lightning cable and Digital AV adapter (these items may be purchased separately from your Honda Dealer). Apple, iPhone and Siri are trademarks of Apple Inc., registered in the U.S. and other countries. HDMI is a registered trademark of HDMI Licensing LLC in the United States and other countries. IOS is a trademark of Cisco in the U.S. and is used under licence. All other trademarks are properties of their respective owners. The Bluetooth word mark is owned by Bluetooth SIG, Inc. and use of such mark by Honda is under licence.

You're never alone in a Honda.

Buy an Odyssey and you'll be amazed at how well you'll be looked after.

The care starts with a 3-year/100,000km warranty and 6-year rust perforation warranty*.

Plus Honda has a range of benefits that ensure your Odyssey is as pleasurable to own as it is to drive.

Dedicated Honda Care

Servicing your Odyssey at a local Honda Dealership will ensure you protect your investment and maximise its outstanding resale value. Dedicated Honda Care provides access to specialist diagnostic equipment and Honda Genuine Parts. There's also the advantage of factory-trained technicians with unparalleled knowledge of Honda products.

Honda Warranty Plus*

Purchase Honda Warranty Plus and your Odyssey will be protected with no claim limits and no cost for labour and parts for 5 years or 140,000 kilometres (inclusive of New Vehicle Warranty). You'll also be entitled to 5 years' Premium Roadside Assist. Visit honda.com.au/warranty for more information.

Honda Financial Services*

Honda cars have a reputation for quality, reliability and great value for money. Our Honda Financial Services products are no different. Competitively priced and packed full of unique features and extras, our comprehensive range of insurance# and finance^ products make it easier to get your new Honda on the road sooner. For more information visit honda.com.au/financialservices

Honda Merchandise

Show your true colours with genuine Honda merchandise. For everything from apparel to travel goods, visit your local Honda Dealer or view the range at honda.com.au/merchandise



For more information visit honda.com.au or Freecall 1800 804 954

*Honda warranties apply where due care is exercised by the owner and the vehicle is maintained in accordance with the Owner's Warranty and Service Manual. Please visit honda.com.au/warranty for full terms and conditions. *5-year/140,000km Warranty Plus is inclusive of 3-year/100,000km New Vehicle Warranty. Please refer to Honda's Warranty documentation for conditions at honda.com.au/warranty #Honda Financial Services is used by Honda Australia Pty Limited to generally describe the insurance products issued under the Honda brand, and finance products issued under the trading name Honda Finance Solutions. Insurance products under the Honda brand are issued by Allianz Australia Insurance Limited ABN 15 000 122 850 AFSL 234708 (Allianz). Finance products are issued under the trading name Honda Finance Solutions by Macquarie Leasing Pty Limited ABN 38 002 674 982 (Australian Credit Licence No. 394925) (Macquarie). #Your Authorised Honda Dealer arranges this insurance as agent of the insurer Allianz. We do not provide advice on this insurance based on any consideration of your objectives, financial situation or needs. Before making a decision, please consider the relevant Product Disclosure Statement available from www.honda.com.au/insurance ^Finance products are provided by Macquarie trading as Honda Finance Solutions, to approved applicants, subject to the satisfaction of assessment and other criteria. Terms, fees and charges apply. Full terms and conditions available on application.

Odyssey VTi-L shown in Premium Twinkle Black Pearlescent.